

Continued.....

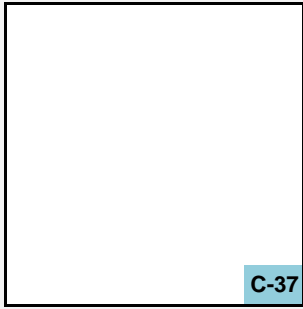

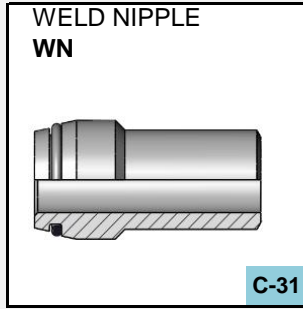
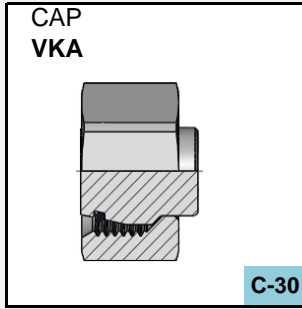
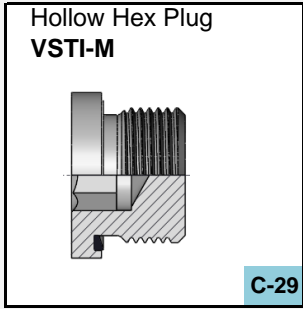
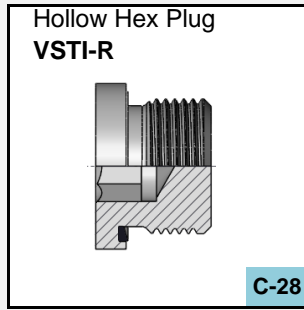
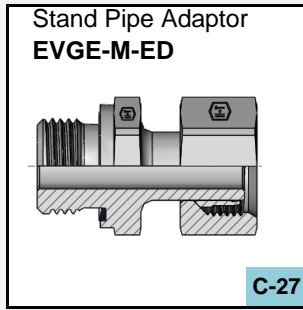
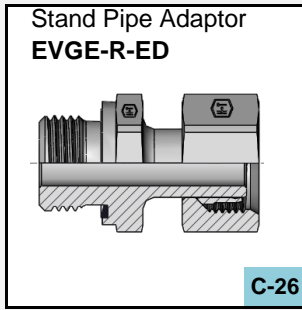
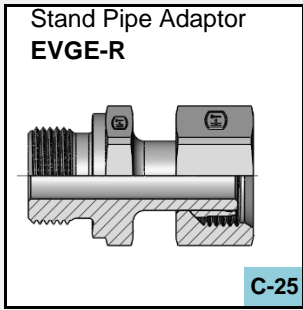
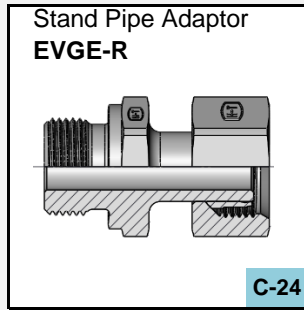
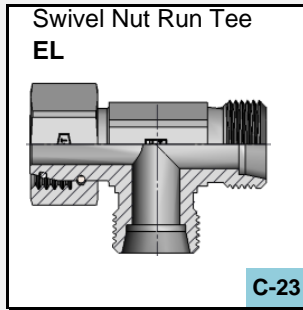
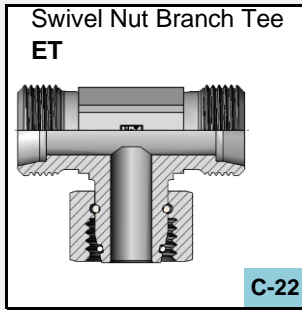
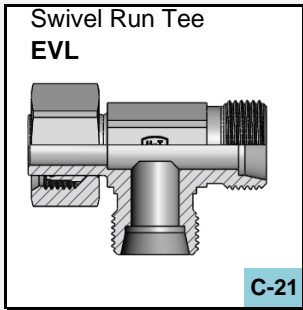
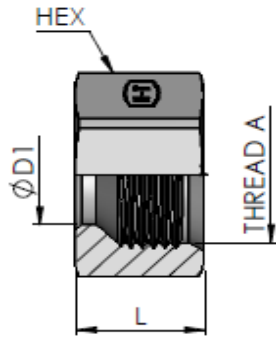

C-01

**N-NUT
L SERIES**

Tube O.D.	HEX	ØD1	L Length	A THREAD	Part Number	Torque N-m	Working pressure in Bar
6	14.00	6.00	14.50	M12X1.5-6H	N06L	13-15	250
8	17.00	8.00	14.50	M14X1.5-6H	N08L	15-18	250
10	19.00	10.00	15.50	M16X1.5-6H	N10L	25-28	250
12	22.00	12.00	15.50	M18X1.5-6H	N12L	27-30	250
15	27.00	15.00	17.00	M22X1.5-6H	N15L	50-60	250
18	32.00	18.00	18.00	M26X1.5-6H	N18L	60-75	160
22	36.00	22.00	20.00	M30X2.0-6H	N22L	85-105	160
28	41.00	28.00	21.00	M36X2.0-6H	N28L	120-140	100
35	50.00	35.00	24.00	M45X2.0-6H	N35L	170-190	100
42	60.00	42.00	24.00	M52X2.0-6H	N42L	190-230	100

S SERIES

Tube O.D.	HEX	ØD1	L Length	A THREAD	PartXNumber	Torque N-m	Working pressure in Bar
6	17.00	6.00	16.50	M14X1.5-6H	N06S	14-16	630
8	19.00	8.00	16.50	M16X1.5-6H	N08S	25-28	630
10	22.00	10.00	17.50	M18X1.5-6H	N10S	27-30	630
12	24.00	12.00	17.50	M20X1.5-6H	N12S	43-54	630
14	27.00	14.00	20.50	M22X1.5-6H	N14S	50-62	630
16	30.00	16.00	20.50	M24X1.5-6H	N106S	60-75	400
20	36.00	20.00	24.00	M30X2.0-6H	N20S	90-110	400
25	46.00	25.00	27.00	M36X2.0-6H	N25S	125-145	400
30	50.00	30.00	29.00	M42X2.0-6H	N30S	170-190	250
38	60.00	38.00	32.50	M52X2.0-6H	N38S	200-245	250

Material	Suffix surface and material	Example
Steel ,Zinc plated chrome (VI)-free		N06L
Steel ,Zinc nickel plated	ZiNi	N06L-ZiNi
Stainless Steel-SS316 Ti	SST	N06L-SST
Stainless Steel-SS316	SS316	N06L-SS
Stainless Steel-SS304	SS304	N06L-S

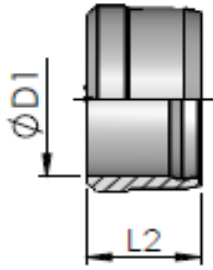

C-02

F-FERRULE

L SERIES

Tube O.D.	ØD1	L2 Length	Part Number	Torque N-m	Working pressure in Bar
6	6.00	9.00	F06L-S	13-15	250
8	8.00	9.00	F08L-S	15-18	250
10	10.00	10.00	F10L-S	25-28	250
12	12.00	10.00	F12L-S	27-30	250
15	15.00	10.00	F15L	50-60	250
18	18.00	10.00	F18L	60-75	160
22	22.00	10.50	F22L	85-105	160
28	28.00	10.50	F28L	120-140	100
35	35.00	13.00	F35L	170-190	100
42	42.00	13.50	F42L	190-230	100

S SERIES

Tube O.D.	ØD1	L2 Length	Part Number	Torque N-m	Working pressure in Bar
6	6.00	9.00	F06L-S	14-16	630
8	8.00	9.00	F08L-S	25-28	630
10	10.00	10.00	F10L-S	27-30	630
12	12.00	10.00	F12L-S	43-54	630
14	14.00	10.00	F14S	50-62	630
16	16.00	10.50	F16S	60-75	400
20	20.00	12.50	F20S	90-110	400
25	25.00	12.50	F25S	125-145	400
30	30.00	13.00	F30S	170-190	250
38	38.00	13.50	F38S	200-245	250

Material	Suffix surface and material	Example
Steel ,Zinc plated chrome (VI)-free		F06L-S
Steel ,Zinc nickel plated	ZiNi	F06L-S-ZiNi

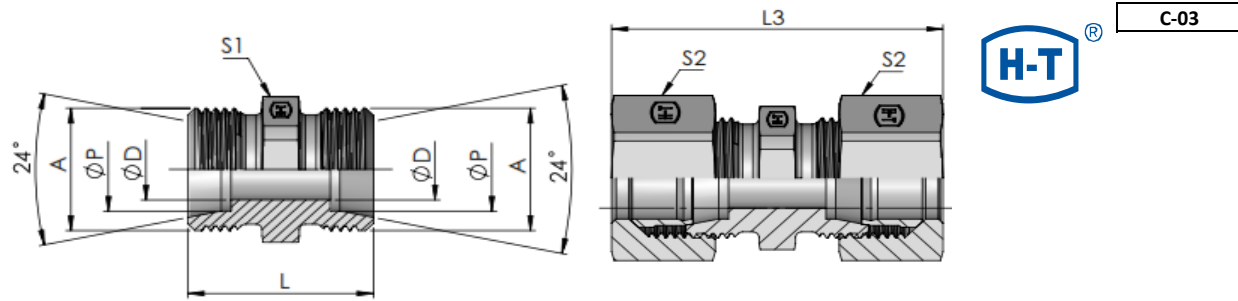

G-Equal Straight Coupling

L SERIES

Tube O.D.	A THREAD	S1 Hex	S2 Hex	L Length	ØD DRILL	ØP	L3	Body Part Number	Assembly Part Number	Torque N-m	Working pressure in Bar
6	M12X1.5-6g	12.00	14.00	24.00	4.00	6.00	39.00	XG06L	G06L	13-15	250
8	M14X1.5-6g	14.00	17.00	25.00	6.00	8.00	40.00	XG08L	G08L	15-18	250
10	M16X1.5-6g	17.00	19.00	27.00	8.00	10.00	42.00	XG10L	G10L	25-28	250
12	M18X1.5-6g	19.00	22.00	28.00	10.00	12.00	43.00	XG12L	G12L	27-30	250
15	M22X1.5-6g	24.00	27.00	30.00	12.00	15.00	46.00	XG15L	G15L	50-60	250
18	M26X1.5-6g	27.00	32.00	31.00	15.00	18.00	48.00	XG18L	G18L	60-75	160
22	M30X2.0-6g	32.00	36.00	35.00	19.00	22.00	52.00	XG22L	G22L	85-105	160
28	M36X2.0-6g	41.00	41.00	36.00	24.00	28.00	54.00	XG28L	G28L	120-140	100
35	M45X2.0-6g	46.00	50.00	41.00	30.00	35.00	63.00	XG35L	G35L	170-190	100
42	M52X2.0-6g	55.00	60.00	43.00	36.00	42.00	66.00	XG42L	G42L	190-230	100

S SERIES

Tube O.D.	A THREAD	S1 Hex	S2 Hex	L Length	ØD DRILL	ØP	L3	Body Part Number	Assembly Part Number	Torque N-m	Working pressure in Bar
6	M14X1.5-6g	14.00	17.00	30.00	4.00	6.00	45.00	XG06S	G06S	14-16	630
8	M16X1.5-6g	17.00	19.00	32.00	5.00	8.00	47.00	XG08S	G08S	25-28	630
10	M18X1.5-6g	19.00	22.00	32.00	7.00	10.00	49.00	XG10S	G10S	27-30	630
12	M20X1.5-6g	22.00	24.00	34.00	8.00	12.00	51.00	XG12S	G12S	43-54	630
16	M24X1.5-6g	27.00	30.00	38.00	12.00	16.00	57.00	XG16S	G16S	60-75	400
20	M30X2.0-6g	32.00	36.00	44.00	16.00	20.00	66.00	XG20S	G20S	90-110	400
25	M36X2.0-6g	41.00	46.00	50.00	20.00	25.00	74.00	XG25S	G25S	125-145	400
30	M42X2.0-6g	46.00	50.00	54.00	25.00	30.00	80.00	XG30S	G30S	170-190	250
38	M52X2.0-6g	55.00	60.00	61.00	32.00	38.00	90.00	XG38S	G38S	200-245	250

Material	Suffix surface and material	Example
Steel ,Zinc plated chrome (VI)-free		XG06L
Steel ,Zinc nickel plated	ZiNi	XG06L-ZiNi
Stainless Steel-SS316 Ti	SST	XG06L-SST
Stainless Steel-SS316	SS316	XG06L-SS
Stainless Steel-SS304	SS304	XG06L-S

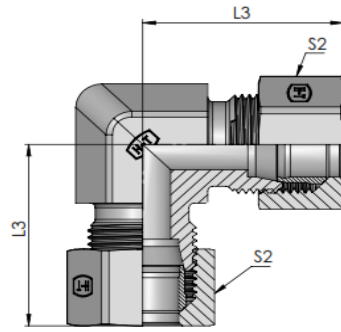
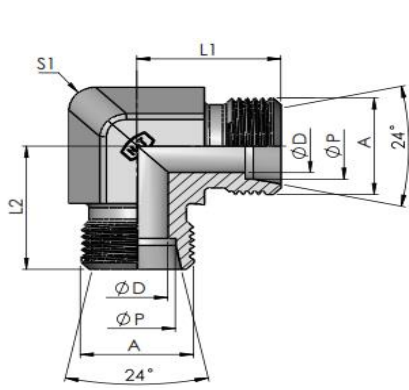

C-04

W-Equal Elbow Union

L SERIES

Tube O.D.	A THREAD	S1 Hex	S2 Hex	L1	L2	ØD DRILL	ØP	L3	Body Part Number	Assembly Part Number	Torque N-m	Working pressure in Bar
6	M12X1.5-6g	12.00	14.00	19.00	19.00	4.00	6.00	27.00	XW06L	W06L	13-15	250
8	M14X1.5-6g	14.00	17.00	21.00	21.00	6.00	8.00	29.00	XW08L	W08L	15-18	250
10	M16X1.5-6g	14.00	19.00	22.00	22.00	8.00	10.00	30.00	XW10L	W10L	25-28	250
12	M18X1.5-6g	17.00	22.00	24.00	24.00	10.00	12.00	32.00	XW12L	W12L	27-30	250
15	M22X1.5-6g	24.00	27.00	28.00	28.00	12.00	15.00	36.00	XW15L	W15L	50-60	250
18	M26X1.5-6g	24.00	32.00	31.00	31.00	15.00	18.00	40.00	XW18L	W18L	60-75	160
22	M30X2.0-6g	27.00	36.00	35.00	35.00	19.00	22.00	44.00	XW22L	W22L	85-105	160
28	M36X2.0-6g	36.00	41.00	38.00	38.00	24.00	28.00	47.00	XW28L	W28L	120-140	100
35	M45X2.0-6g	41.00	50.00	45.00	45.00	30.00	35.00	56.00	XW35L	W35L	170-190	100
42	M52X2.0-6g	50.00	60.00	51.00	51.00	36.00	42.00	63.00	XW42L	W42L	190-230	100

S SERIES

Tube O.D.	A THREAD	S1 Hex	S2 Hex	L1	L2	ØD DRILL	ØP	L3	Body Part Number	Assembly Part Number	Torque N-m	Working pressure in Bar
6	M14X1.5-6g	14.00	17.00	23.00	23.00	4.00	6.00	31.00	XW06S	W06S	14-16	630
8	M16X1.5-6g	14.00	19.00	24.00	24.00	5.00	8.00	32.00	XW08S	W08S	25-28	630
10	M18X1.5-6g	17.00	22.00	25.00	25.00	7.00	10.00	34.00	XW10S	W10S	27-30	630
12	M20X1.5-6g	17.00	24.00	29.00	29.00	8.00	12.00	38.00	XW12S	W12S	43-54	630
14	M22X1.5-6g	24.00	27.00	30.00	30.00	10.00	14.00	40.00	XW14S	W14S	50-62	630
16	M24X1.5-6g	24.00	30.00	33.00	33.00	12.00	16.00	43.00	XW16S	W16S	60-75	400
20	M30X2.0-6g	27.00	36.00	37.00	37.00	16.00	20.00	48.00	XW20S	W20S	90-110	400
25	M36X2.0-6g	36.00	46.00	42.00	42.00	20.00	25.00	54.00	XW25S	W25S	125-145	400
30	M42X2.0-6g	41.00	50.00	49.00	49.00	25.00	30.00	62.00	XW30S	W30S	170-190	250
38	M52X2.0-6g	50.00	60.00	57.00	57.00	32.00	38.00	72.00	XW38S	W38S	200-245	250

Material	Suffix surface and material	Example
Steel ,Zinc plated chrome (VI)-free		XW06L
Steel ,Zinc nickel plated	ZiNi	XW06L-ZiNi
Stainless Steel-SS316 Ti	SST	XW06L-SST
Stainless Steel-SS316	SS316	XW06L-SS
Stainless Steel-SS304	SS304	XW06L-S



C-05

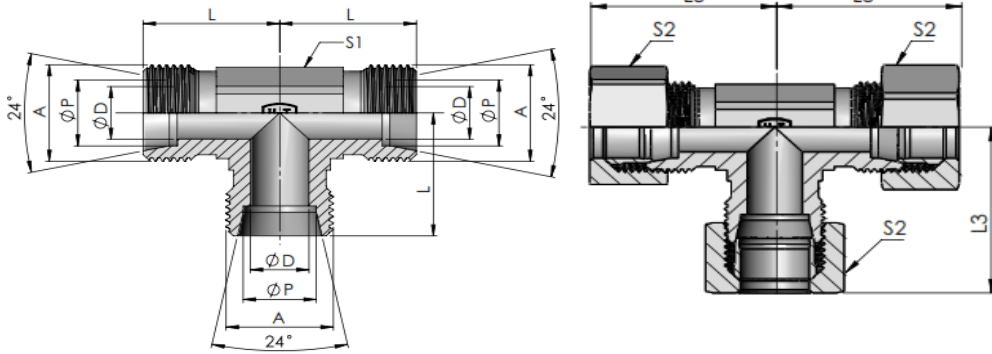

**T-Equal Tee Union
L SERIES**

Tube O.D.	A THREAD	S1 Hex	S2 Hex	L	ØD DRILL	ØP	L3	Body Part Number	Assembly Part Number	Torque N-m	Working pressure in Bar
6	M12X1.5-6g	12.00	14.00	19.00	4.00	6.00	27.00	XT06L	T06L	13-15	250
8	M14X1.5-6g	14.00	17.00	21.00	6.00	8.00	29.00	XT08L	T08L	15-18	250
10	M16X1.5-6g	14.00	19.00	22.00	8.00	10.00	30.00	XT10L	T10L	25-28	250
12	M18X1.5-6g	17.00	22.00	24.00	10.00	12.00	32.00	XT12L	T12L	27-30	250
15	M22X1.5-6g	19.00	27.00	28.00	12.00	15.00	36.00	XT15L	T15L	50-60	250
18	M26X1.5-6g	24.00	32.00	31.00	15.00	18.00	40.00	XT18L	T18L	60-75	160
22	M30X2.0-6g	27.00	36.00	35.00	19.00	22.00	44.00	XT22L	T22L	85-105	160
28	M36X2.0-6g	36.00	41.00	38.00	24.00	28.00	47.00	XT28L	T28L	120-140	100
35	M45X2.0-6g	41.00	50.00	45.00	30.00	35.00	56.00	XT35L	T35L	170-190	100
42	M52X2.0-6g	50.00	60.00	51.00	36.00	42.00	63.00	XT42L	T42L	190-230	100

S SERIES

Tube O.D.	A THREAD	S1 Hex	S2 Hex	L	ØD DRILL	ØP	L3	Body Part Number	Assembly Part Number	Torque N-m	Working pressure in Bar
6	M14X1.5-6g	14.00	17.00	23.00	4.00	6.00	31.00	XT06S	T06S	14-16	630
8	M16X1.5-6g	14.00	19.00	24.00	5.00	8.00	32.00	XT08S	T08S	25-28	630
10	M18X1.5-6g	17.00	22.00	25.00	7.00	10.00	34.00	XT10S	T10S	27-30	630
12	M20X1.5-6g	17.00	24.00	29.00	8.00	12.00	38.00	XT12S	T12S	43-54	630
14	M22X1.5-6g	24.00	27.00	30.00	10.00	14.00	40.00	XT14S	T12S	50-62	630
16	M24X1.5-6g	24.00	30.00	33.00	12.00	16.00	43.00	XT16S	T16S	60-75	400
20	M30X2.0-6g	27.00	36.00	37.00	16.00	20.00	48.00	XT20S	T20S	90-110	400
25	M36X2.0-6g	36.00	46.00	42.00	20.00	25.00	54.00	XT25S	T25S	125-145	400
30	M42X2.0-6g	41.00	50.00	49.00	25.00	30.00	62.00	XT30S	T30S	170-190	250
38	M52X2.0-6g	50.00	60.00	57.00	32.00	38.00	72.00	XT38S	T38S	200-245	250

Material	Suffix surface and material	Example
Steel ,zinc plated chrome (VI)-free		XT06L
Steel ,zinc nickel plated	ZiNi	XT06L-ZiNi
Stainless Steel-SS316 Ti	SST	XT06L-SST
Stainless Steel-SS316	SS316	XT06L-SS
Stainless Steel-SS304	SS304	XT06L-S

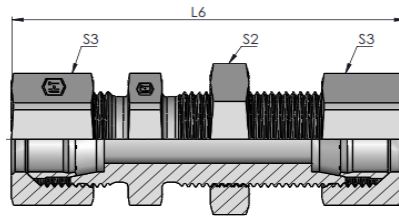
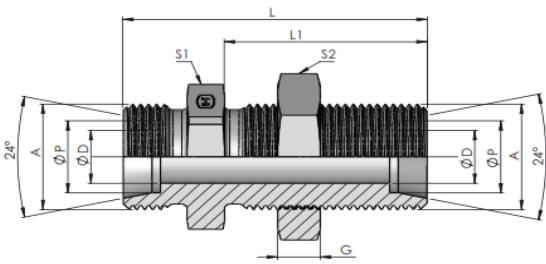

C-06

SV-Bulkhead Straight Coupling

L SERIES

Tube O.D.	A THREAD	S1 Hex	S2 Hex	S3 Hex	L	L1	ØD DRILL	ØP	G	L6	Body Part Number	Assembly Part Number	Torque N-m	Working pressure in Bar
6	M12X1.5-6g	17.00	17.00	14.00	48.00	34.00	4.00	6.00	5.00	64.00	XSV06L	SV06L	13-15	250
8	M14X1.5-6g	19.00	19.00	17.00	49.00	34.00	6.00	8.00	5.50	65.00	XSV08L	SV08L	15-18	250
10	M16X1.5-6g	22.00	22.00	19.00	52.00	35.00	8.00	10.00	6.00	68.00	XSV10L	SV10L	25-28	250
12	M18X1.5-6g	24.00	24.00	22.00	53.00	36.00	10.00	12.00	7.00	69.00	XSV12L	SV12L	27-30	250
15	M22X1.5-6g	27.00	30.00	27.00	57.00	38.00	12.00	15.00	8.00	73.00	XSV15L	SV15L	50-60	250
18	M26X1.5-6g	32.00	36.00	32.00	61.00	40.00	15.00	18.00	8.00	79.00	XSV18L	SV18L	60-75	160
22	M30X2.0-6g	36.00	41.00	36.00	66.00	42.00	19.00	22.00	10.00	84.00	XSV22L	SV22L	85-105	160
28	M36X2.0-6g	41.00	46.00	41.00	69.00	43.00	24.00	28.00	12.00	107.00	XSV28L	SV28L	120-140	100
35	M45X2.0-6g	50.00	55.00	50.00	76.00	47.00	30.00	35.00	11.00	98.00	XSV35L	SV35L	170-190	100
42	M52X2.0-6g	60.00	65.00	60.00	77.00	47.00	36.00	42.00	14.00	101.00	XSV42L	SV42L	190-230	100

S SERIES

Tube O.D.	A THREAD	S1 Hex	S2 Hex	S3 Hex	L	L1	ØD DRILL	ØP	G	L6	Body Part Number	Assembly Part Number	Torque N-m	Working pressure in Bar
6	M14X1.5-6g	19.00	19.00	17.00	55.00	36.00	4.00	6.00	5.50	71.00	XSV06S	SV06S	14-16	630
8	M16X1.5-6g	22.00	22.00	19.00	56.00	36.00	5.00	8.00	6.00	72.00	XSV08S	SV08S	25-28	630
10	M18X1.5-6g	24.00	24.00	22.00	59.00	37.00	7.00	10.00	7.00	77.00	XSV10S	SV10S	27-30	630
12	M20X1.5-6g	27.00	27.00	24.00	60.00	38.00	8.00	12.00	7.00	78.00	XSV12S	SV12S	43-54	630
14	M22X1.5-6g	30.00	30.00	27.00	64.00	40.00	10.00	14.00	8.00	85.00	XSV14S	SV14S	50-62	630
16	M24X1.5-6g	32.00	32.00	30.00	65.00	40.00	12.00	16.00	10.00	85.00	XSV16S	SV16S	60-75	400
20	M30X2.0-6g	41.00	41.00	36.00	72.00	44.00	16.00	20.00	10.00	94.00	XSV20S	SV20S	90-110	400
25	M36X2.0-6g	46.00	46.00	46.00	79.00	47.00	20.00	25.00	12.00	103.00	XSV25S	SV25S	125-145	400
30	M42X2.0-6g	50.00	50.00	50.00	86.00	51.00	25.00	30.00	11.00	112.00	XSV30S	SV30S	170-190	250
38	M52X2.0-6g	65.00	65.00	60.00	91.00	53.00	32.00	38.00	14.00	121.00	XSV38S	SV38S	200-245	250

Material	Suffix surface and material	Example
Steel ,Zinc plated chrome (VI)-free		XSV06L
Steel ,Zinc nickel plated	ZiNi	XSV06L-ZiNi
Stainless Steel-SS316 Ti	SST	XSV06L-SST
Stainless Steel-SS316	SS316	XSV06L-SS
Stainless Steel-SS304	SS304	XSV06L-S

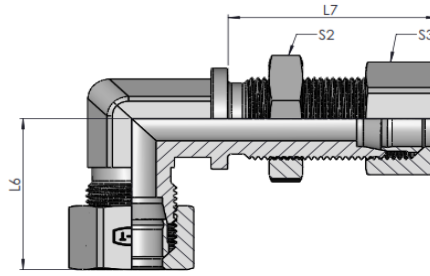
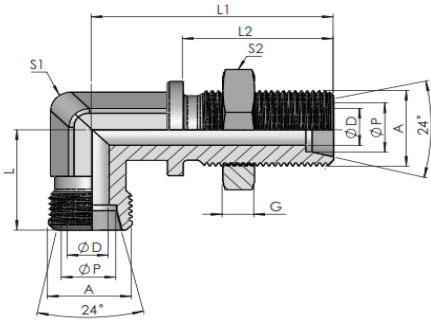

C-07

WSV-Bulkhead Union Elbow

L SERIES

Tube O.D.	A THREAD	S1 Hex	S2 Hex	S3 Hex	L	L1	L2	ØD DRILL	ØP	G	L6	L7	Body Part Number	Assembly Part Number	Torque N-m	Working pressure in Bar
6	M12X1.5-6g	12.00	17.00	14.00	20.50	48.00	34.00	4.00	6.00	5.00	27.00	42.00	XWSV06L	WSV06L	13-15	250
8	M14X1.5-6g	12.00	19.00	17.00	21.00	51.00	34.00	6.00	8.00	5.50	29.00	42.00	XWSV08L	WSV08L	15-18	250
10	M16X1.5-6g	14.00	22.00	19.00	25.00	53.00	35.00	8.00	10.00	6.00	30.00	43.00	XWSV10L	WSV10L	25-28	250
12	M18X1.5-6g	17.00	24.00	22.00	26.50	56.00	36.00	10.00	12.00	7.00	32.00	44.00	XWSV12L	WSV12L	27-30	250
15	M22X1.5-6g	24.00	30.00	27.00	28.00	61.00	38.00	12.00	15.00	8.00	36.00	46.00	XWSV15L	WSV15L	50-60	250
18	M26X1.5-6g	24.00	36.00	32.00	31.00	64.00	40.00	15.00	18.00	8.00	40.00	49.00	XWSV18L	WSV18L	60-75	160
22	M30X2.0-6g	27.00	41.00	36.00	35.00	72.00	42.00	19.00	22.00	10.00	44.00	51.00	XWSV22L	WSV22L	85-105	160
28	M36X2.0-6g	36.00	46.00	41.00	38.00	77.00	43.00	24.00	28.00	12.00	47.00	52.00	XWSV28L	WSV28L	120-140	100
35	M45X2.0-6g	41.00	55.00	50.00	42.00	86.00	47.00	30.00	35.00	11.00	56.00	58.00	XWSV35L	WSV35L	170-190	100
42	M52X2.0-6g	50.00	65.00	60.00	51.00	90.00	47.00	36.00	42.00	14.00	63.00	59.00	XWSV42L	WSV42L	190-230	100

S SERIES

Tube O.D.	A THREAD	S1 Hex	S2 Hex	S3 Hex	L	L1	L2	ØD DRILL	ØP	G	L6	L7	Body Part Number	Assembly Part Number	Torque N-m	Working pressure in Bar
6	M14X1.5-6g	12.00	19.00	17.00	23.00	53.00	36.00	4.00	6.00	5.50	31.00	44.00	XWSV06S	WSV06S	14-16	630
8	M16X1.5-6g	14.00	22.00	19.00	24.00	54.00	36.00	5.00	8.00	6.00	32.00	44.00	XWSV08S	WSV08S	25-28	630
10	M18X1.5-6g	17.00	24.00	22.00	25.00	57.00	37.00	7.00	10.00	7.00	34.00	46.00	XWSV10S	WSV10S	27-30	630
12	M20X1.5-6g	17.00	27.00	24.00	29.00	59.00	38.00	8.00	12.00	7.00	38.00	47.00	XWSV12S	WSV12S	43-54	630
14	M22X1.5-6g	19.00	30.00	27.00	30.00	63.00	40.00	10.00	14.00	8.00	40.00	50.00	XWSV14S	WSV14S	50-62	630
16	M24X1.5-6g	24.00	32.00	30.00	33.00	64.00	40.00	12.00	16.00	10.00	43.00	50.00	XWSV16S	WSV16S	60-75	400
20	M30X2.0-6g	27.00	41.00	36.00	37.00	74.00	44.00	16.00	20.00	10.00	48.00	55.00	XWSV20S	WSV20S	90-110	400
25	M36X2.0-6g	36.00	46.00	46.00	42.00	81.00	47.00	20.00	25.00	12.00	54.00	59.00	XWSV25S	WSV25S	125-145	400
30	M42X2.0-6g	41.00	50.00	50.00	49.00	90.00	51.00	25.00	30.00	11.00	62.00	64.00	XWSV30S	WSV30S	170-190	250
38	M52X2.0-6g	50.00	65.00	60.00	57.00	96.00	53.00	32.00	38.00	14.00	72.00	68.00	XWSV38S	WSV38S	200-245	250

Material	Suffix surface and material	Example
Steel ,Zinc plated chrome (VI)-free		XWSV06L
Steel ,Zinc nickel plated	ZiNi	XWSV06L-ZiNi
Stainless Steel-SS316 Ti	SST	XWSV06L-SST
Stainless Steel-SS316	SS316	XWSV06L-SS
Stainless Steel-SS304	SS304	XWSV06L-S

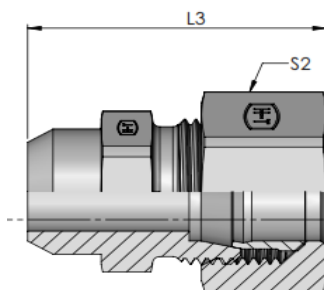
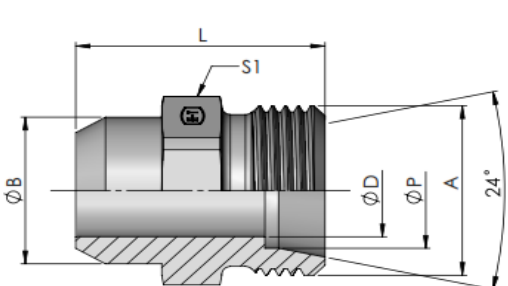

C-08

AS-Welding Connector

L SERIES

Tube O.D.	A THREAD	S1 Hex	S2 Hex	L	ØB	ØD DRILL	ØP	L3	Body Part Number	Assembly Part Number	Torque N-m	Working pressure in Bar
6	M12X1.5-6g	12.00	14.00	21.00	10.00	4.00	6.00	29.00	XAS06L	AS06L	13-15	250
8	M14X1.5-6g	14.00	17.00	23.00	12.00	6.00	8.00	31.00	XAS08L	AS08L	15-18	250
10	M16X1.5-6g	17.00	19.00	25.00	14.00	8.00	10.00	33.00	XAS10L	AS10L	25-28	250
12	M18X1.5-6g	19.00	22.00	25.00	16.00	10.00	12.00	33.00	XAS12L	AS12L	27-30	250
15	M22X1.5-6g	22.00	27.00	29.00	19.00	12.00	15.00	37.00	XAS15L	AS15L	50-60	250
18	M26X1.5-6g	27.00	32.00	31.00	22.00	15.00	18.00	40.00	XAS18L	AS18L	60-75	160
22	M30X2.0-6g	32.00	36.00	36.00	27.00	19.00	22.00	45.00	XAS22L	AS22L	85-105	160
28	M36X2.0-6g	41.00	41.00	38.00	32.00	24.00	28.00	47.00	XAS28L	AS28L	120-140	100
35	M45X2.0-6g	46.00	50.00	43.00	40.00	30.00	35.00	54.00	XAS35L	AS35L	170-190	100
42	M52X2.0-6g	55.00	60.00	46.00	46.00	36.00	42.00	58.00	XAS42L	AS42L	190-230	100

S SERIES

Tube O.D.	A THREAD	S1 Hex	S2 Hex	L	ØB	ØD DRILL	ØP	L3	Body Part Number	Assembly Part Number	Torque N-m	Working pressure in Bar
6	M14X1.5-6g	14.00	17.00	26.00	11.00	4.00	6.00	34.00	XAS06S	AS06S	14-16	630
8	M16X1.5-6g	17.00	19.00	28.00	13.00	5.00	8.00	36.00	XAS08S	AS08S	25-28	630
10	M18X1.5-6g	19.00	22.00	30.00	15.00	7.00	10.00	39.00	XAS10S	AS10S	27-30	630
12	M20X1.5-6g	22.00	24.00	32.00	17.00	8.00	12.00	41.00	XAS12S	AS12S	43-54	630
14	M22X1.5-6g	24.00	27.00	35.00	19.00	10.00	14.00	45.00	XAS14S	AS14S	50-62	630
16	M24X1.5-6g	27.00	30.00	35.00	21.00	12.00	16.00	45.00	XAS16S	AS16S	60-75	400
20	M30X2.0-6g	32.00	36.00	40.00	26.00	16.00	20.00	51.00	XAS20S	AS20S	90-110	400
25	M36X2.0-6g	41.00	46.00	44.00	31.00	20.00	25.00	56.00	XAS25S	AS25S	125-145	400
30	M42X2.0-6g	46.00	50.00	49.00	36.00	25.00	30.00	62.00	XAS30S	AS30S	170-190	250
38	M52X2.0-6g	55.00	60.00	54.00	44.00	32.00	38.00	69.00	XAS38S	AS38S	200-245	250

Material	Suffix surface and material	Example
Steel ,Zinc plated chrome (VI)-free		XAS06L
Steel ,Zinc nickel plated	ZiNi	XAS06L-ZiNi
Stainless Steel-SS316 Ti	SST	XAS06L-SST
Stainless Steel-SS316	SS316	XAS06L-SS
Stainless Steel-SS304	SS304	XAS06L-S



C-09

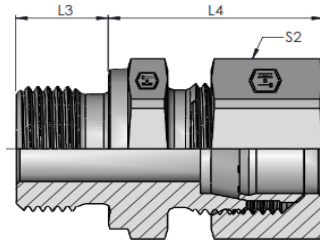
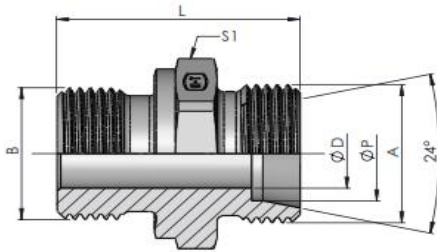

GE-R-Parallel Male Stud Coupling

L SERIES

Tube O.D.	A THREAD	B THREAD	S1 Hex	S2 Hex	L	ØD DRILL	ØP	L3	L4	Body Part Number	Assembly Part Number	Torque N-m	Working pressure in Bar
6	M12X1.5-6g	G1/8"-28-BSPP-A	14.00	14.00	23.50	4.00	6.00	12.00	28.00	XGE06LR	GE06LR	13-15	250
8	M14X1.5-6g	G1/4"-19-BSPP-A	19.00	17.00	29.00	6.00	8.00	12.00	30.00	XGE08LR	GE08LR	15-18	250
10	M16X1.5-6g	G1/4"-19-BSPP-A	19.00	19.00	30.00	6.00	10.00	12.00	31.00	XGE10LR	GE10LR	25-28	250
12	M18X1.5-6g	G3/8"-19-BSPP-A	22.00	22.00	31.50	9.00	12.00	12.00	33.00	XGE12LR	GE12LR	27-30	250
15	M22X1.5-6g	G1/2"-14-BSPP-A	27.00	27.00	32.50	11.00	15.00	14.00	37.00	XGE15LR	GE15LR	50-60	250
18	M26X1.5-6g	G1/2"-14-BSPP-A	27.00	32.00	36.00	14.00	18.00	14.00	37.00	XGE18LR	GE18LR	60-75	160
22	M30X2.0-6g	G3/4"-14-BSPP-A	32.00	36.00	40.00	18.00	22.00	16.00	42.00	XGE22LR	GE22LR	85-105	160
28	M36X2.0-6g	G1"-11-BSPP-A	41.00	41.00	43.00	23.00	26.00	18.00	47.00	XGE28LR	GE28LR	120-140	100
35	M45X2.0-6g	G1-1/4"-11-BSPP-A	50.00	50.00	48.00	30.00	35.00	20.00	50.00	XGE35LR	GE35LR	170-190	100
42	M52X2.0-6g	G1-1/2"-11-BSPP-A	55.00	60.00	52.00	36.00	42.00	22.00	57.00	XGE42LR	GE42LR	190-230	100

S SERIES

Tube O.D.	A THREAD	B THREAD	S1 Hex	S2 Hex	L	ØD DRILL	ØP	L3	L4	Body Part Number	Assembly Part Number	Torque N-m	Working pressure in Bar
6	M14X1.5-6g	G1/4"-19-BSPP-A	19.00	17.00	32.00	4.00	6.00	8.00	23.00	XGE06SR	GE06SR	14-16	630
8	M16X1.5-6g	G1/4"-19-BSPP-A	19.00	19.00	34.00	5.00	8.00	12.00	25.00	XGE08SR	GE08SR	25-28	630
10	M18X1.5-6g	G3/8"-19-BSPP-A	22.00	22.00	34.50	7.00	10.00	12.00	26.00	XGE10SR	GE10SR	27-30	630
12	M20X1.5-6g	G3/8"-19-BSPP-A	22.00	24.00	36.50	8.00	12.00	12.00	27.00	XGE12SR	GE12SR	43-54	630
14	M22X1.5-6g	G1/2"-14-BSPP-A	27.00	27.00	41.00	10.00	14.00	14.00	29.00	XGE14SR	GE14SR	50-62	630
16	M24X1.5-6g	G1/2"-14-BSPP-A	27.00	30.00	41.00	12.00	16.00	14.00	31.00	XGE16SR	GE16SR	60-75	400
20	M30X2.0-6g	G3/4"-14-BSPP-A	32.00	36.00	47.00	16.00	20.00	16.00	33.00	XGE20SR	GE20SR	90-110	400
25	M36X2.0-6g	G1"-11-BSPP-A	41.00	46.00	53.00	20.00	25.00	18.00	34.00	XGE25SR	GE25SR	125-145	400
30	M42X2.0-6g	G1-1/4"-11-BSPP-A	50.00	50.00	57.00	25.00	30.00	20.00	39.00	XGE30SR	GE30SR	170-190	250
38	M52X2.0-6g	G1-1/2"-11-BSPP-A	55.00	60.00	64.00	32.00	38.00	22.00	42.00	XGE38SR	GE38SR	200-245	250

Material	Suffix surface and material	Example
Steel ,Zinc plated chrome (VI)-free		XGE06LR
Steel ,Zinc nickel plated	ZiNi	XGE06LR-ZiNi
Stainless Steel-SS316 Ti	SST	XGE06LR-SST
Stainless Steel-SS316	SS316	XGE06LR-SS
Stainless Steel-SS304	SS304	XGE06LR-S

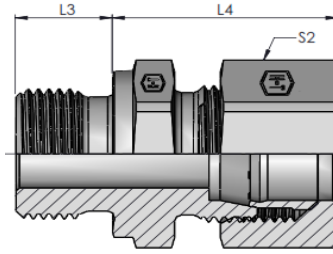
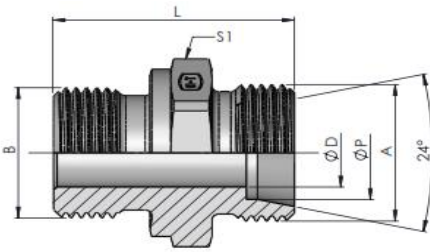

C-10

GE-M-Parallel Male Stud Coupling

L SERIES

Tube O.D.	A THREAD	B THREAD	S1 Hex	S2 Hex	L	ØD DRILL	ØP	L3	L4	Body Part Number	Assembly Part Number	Torque N-m	Working pressure in Bar
6	M12X1.5-6g	M10X1.0-6g	14.00	14.00	23.50	4.00	6.00	8.00	23.00	XGE06LM	GE06LM	13-15	250
8	M14X1.5-6g	M12X1.5-6g	17.00	17.00	29.00	6.00	8.00	12.00	25.00	XGE08LM	GE08LM	15-18	250
10	M16X1.5-6g	M14X1.5-6g	19.00	19.00	30.00	7.00	10.00	12.00	26.00	XGE10LM	GE10LM	25-28	250
12	M18X1.5-6g	M16X1.5-6g	22.00	22.00	31.50	9.00	12.00	12.00	27.00	XGE12LM	GE12LM	27-30	250
15	M22X1.5-6g	M18X1.5-6g	24.00	27.00	32.50	11.00	15.00	12.00	29.00	XGE15LM	GE15LM	50-60	250
18	M26X1.5-6g	M22X1.5-6g	27.00	32.00	36.00	14.00	18.00	14.00	31.00	XGE18LM	GE18LM	60-75	160
22	M30X2.0-6g	M26X1.5-6g	32.00	36.00	40.00	18.00	22.00	16.00	33.00	XGE22LM	GE22LM	85-105	160
28	M36X2.0-6g	M33X2.0-6g	41.00	41.00	43.00	23.00	28.00	18.00	34.00	XGE28LM	GE28LM	120-140	100
35	M45X2.0-6g	M42X2.0-6g	50.00	50.00	48.00	30.00	35.00	20.00	39.00	XGE35LM	GE35LM	170-190	100
42	M52X2.0-6g	M48X2.0-6g	55.00	60.00	52.00	36.00	42.00	22.00	42.00	XGE42LM	GE42LM	190-230	100

S SERIES

Tube O.D.	A THREAD	B THREAD	S1 Hex	S2 Hex	L	ØD DRILL	ØP	L3	L4	Body Part Number	Assembly Part Number	Torque N-m	Working pressure in Bar
6	M14X1.5-6g	M12X1.5-6g	17.00	17.00	32.00	4.00	6.00	12.00	28.00	XGE06SM	GE06SM	14-16	630
8	M16X1.5-6g	M14X1.5-6g	19.00	19.00	34.00	5.00	8.00	12.00	30.00	XGE08SM	GE08SM	25-28	630
10	M18X1.5-6g	M16X1.5-6g	22.00	22.00	34.50	7.00	10.00	12.00	31.00	XGE10SM	GE10SM	27-30	630
12	M20X1.5-6g	M18X1.5-6g	22.00	24.00	36.50	8.00	12.00	12.00	33.00	XGE12SM	GE12SM	43-54	630
14	M22X1.5-6g	M20X1.5-6g	27.00	27.00	41.00	10.00	14.00	14.00	37.00	XGE14SM	GE14SM	50-62	630
16	M24X1.5-6g	M22X1.5-6g	27.00	30.00	41.00	12.00	16.00	14.00	37.00	XGE16SM	GE16SM	60-75	400
20	M30X2.0-6g	M27X2.0-6g	32.00	36.00	47.00	16.00	20.00	16.00	42.00	XGE20SM	GE20SM	90-110	400
25	M36X2.0-6g	M33X2.0-6g	41.00	46.00	53.00	20.00	25.00	18.00	47.00	XGE25SM	GE25SM	125-145	400
30	M42X2.0-6g	M42X2.0-6g	50.00	50.00	57.00	25.00	30.00	20.00	50.00	XGE30SM	GE30SM	170-190	250
38	M52X2.0-6g	M48X2.0-6g	55.00	60.00	64.00	32.00	38.00	22.00	57.00	XGE38SM	GE38SM	200-245	250

Material	Suffix surface and material	Example
Steel ,Zinc plated chrome (VI)-free		XGE06SM
Steel ,Zinc nickel plated	ZiNi	XGE06SM-ZiNi
Stainless Steel-SS316 Ti	SST	XGE06SM-SST
Stainless Steel-SS316	SS316	XGE06SM-SS
Stainless Steel-SS304	SS304	XGE06SM-S

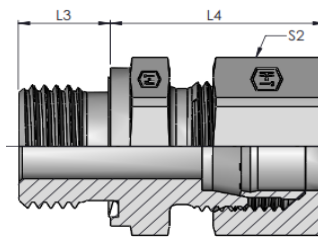
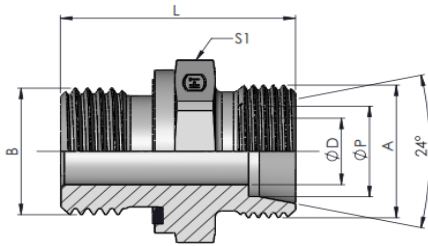

GE-R-ED - Parallel Male Stud Coupling

L SERIES

Tube O.D.	A THREAD	B THREAD	S1 Hex	S2 Hex	L	ØD DRILL	ØP	L3	L4	Body Part Number	Assembly Part Number	Torque N-m	Working pressure in Bar
6	M12X1.5-6g	G1/8"-28-BSPP-A	14.00	14.00	23.50	4.00	6.00	8.00	23.00	XGE06LRED	GE06LRED	13-15	250
8	M14X1.5-6g	G1/4"-19-BSPP-A	19.00	17.00	29.00	6.00	8.00	12.00	25.00	XGE08LRED	GE08LRED	15-18	250
10	M16X1.5-6g	G1/4"-19-BSPP-A	19.00	19.00	30.00	6.00	10.00	12.00	26.00	XGE10LRED	GE10LRED	25-28	250
12	M18X1.5-6g	G3/8"-19-BSPP-A	22.00	22.00	31.50	9.00	12.00	12.00	27.00	XGE12LRED	GE12LRED	27-30	250
15	M22X1.5-6g	G1/2"-14-BSPP-A	27.00	27.00	35.00	11.00	15.00	14.00	29.00	XGE15LRED	GE15LRED	50-60	250
18	M26X1.5-6g	G1/2"-14-BSPP-A	27.00	32.00	36.00	14.00	18.00	14.00	31.00	XGE18LRED	GE18LRED	60-75	160
22	M30X2.0-6g	G3/4"-14-BSPP-A	32.00	36.00	40.00	18.00	22.00	16.00	33.00	XGE22LRED	GE22LRED	85-105	160
28	M36X2.0-6g	G1"-11-BSPP-A	41.00	41.00	43.00	23.00	28.00	18.00	34.00	XGE28LRED	GE28LRED	120-140	100
35	M45X2.0-6g	G1-1/4"-11-BSPP-A	50.00	50.00	48.00	30.00	35.30	20.00	39.00	XGE35LRED	GE35LRED	170-190	100
42	M52X2.0-6g	G1-1/2"-11-BSPP-A	55.00	60.00	52.00	36.00	42.30	22.00	42.00	XGE42LRED	GE42LRED	190-230	100

S SERIES

Tube O.D.	A THREAD	B THREAD	S1 Hex	S2 Hex	L	ØD DRILL	ØP	L3	L4	Body Part Number	Assembly Part Number	Torque N-m	Working pressure in Bar
6	M14X1.5-6g	G1/4"-19-BSPP-A	19.00	17.00	32.00	4.00	6.00	12.00	28.00	XGE06SRED	GE06SRED	14-16	630
8	M16X1.5-6g	G1/4"-19-BSPP-A	19.00	19.00	34.00	5.00	8.00	12.00	30.00	XGE08SRED	GE08SRED	25-28	630
10	M18X1.5-6g	G3/8"-19-BSPP-A	22.00	22.00	34.50	7.00	10.00	12.00	31.00	XGE10SRED	GE10SRED	27-30	630
12	M20X1.5-6g	G3/8"-19-BSPP-A	22.00	24.00	36.50	8.00	12.00	12.00	33.00	XGE12SRED	GE12SRED	43-54	630
14	M22X1.5-6g	G1/2"-14-BSPP-A	27.00	27.00	41.00	10.00	14.00	14.00	37.00	XGE14SRED	GE14SRED	50-62	630
16	M24X1.5-6g	G1/2"-14-BSPP-A	27.00	30.00	41.00	12.00	16.00	14.00	37.00	XGE16SRED	GE16SRED	60-75	400
20	M30X2.0-6g	G3/4"-14-BSPP-A	32.00	36.00	47.00	16.00	20.00	14.00	42.00	XGE20SRED	GE20SRED	90-110	400
25	M36X2.0-6g	G1"-11-BSPP-A	41.00	46.00	53.00	20.00	25.00	18.00	47.00	XGE25SRED	GE25SRED	125-145	400
30	M42X2.0-6g	G1-1/4"-11-BSPP-A	50.00	50.00	57.00	25.00	30.00	20.00	50.00	XGE30SRED	GE30SRED	170-190	250
38	M52X2.0-6g	G1-1/2"-11-BSPP-A	55.00	60.00	64.00	32.00	38.00	22.00	57.00	XGE38SRED	GE38SRED	200-245	250

Material	Suffix surface and material	Example
Steel, Zinc plated chrome (VI)-free		XGE06LRED
Steel, Zinc nickel plated	ZiNi	XGE06LRED-ZiNi
Stainless Steel-SS316 Ti	SST	XGE06LRED-SST
Stainless Steel-SS316	SS316	XGE06LRED-SS
Stainless Steel-SS304	SS304	XGE06LRED-S

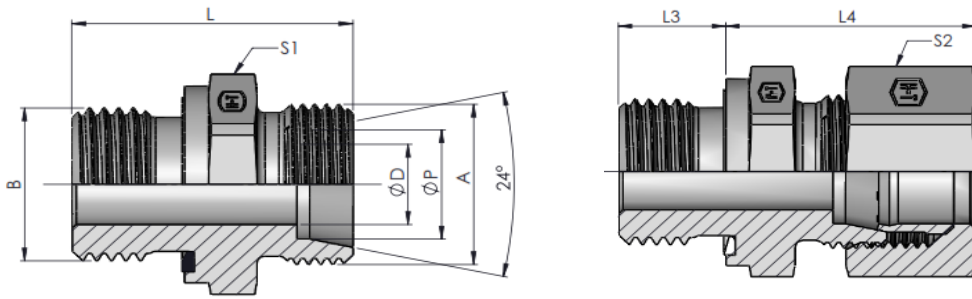

GE-M-ED - Parallel Male Stud Coupling
L SERIES

Tube O.D.	A THREAD	B THREAD	S1 Hex	S2 Hex	L	ØD DRILL	ØP	L3	L4	Body Part Number	Assembly Part Number	Torque N-m	Working pressure in Bar
6	M12X1.5-6g	M10X1.0-6g	14.00	14.00	23.50	4.00	6.00	8.00	23.00	XGE06LMED	GE06LMED	13-15	250
8	M14X1.5-6g	M12X1.5-6g	17.00	17.00	29.00	6.00	8.00	12.00	25.00	XGE08LMED	GE08LMED	15-18	250
10	M16X1.5-6g	M14X1.5-6g	19.00	19.00	30.00	7.00	10.00	12.00	26.00	XGE10LMED	GE10LMED	25-28	250
12	M18X1.5-6g	M16X1.5-6g	22.00	22.00	31.50	9.00	12.00	12.00	27.00	XGE12LMED	GE12LMED	27-30	250
15	M22X1.5-6g	M18X1.5-6g	24.00	27.00	32.50	11.00	15.00	12.00	29.00	XGE15LMED	GE15LMED	50-60	250
18	M26X1.5-6g	M22X1.5-6g	27.00	32.00	36.00	14.00	18.00	14.00	31.00	XGE18LMED	GE18LMED	60-75	160
22	M30X2.0-6g	M26X1.5-6g	32.00	36.00	40.00	18.00	22.00	16.00	33.00	XGE22LMED	GE22LMED	85-105	160
28	M36X2.0-6g	M33X2.0-6g	41.00	41.00	43.00	23.00	28.00	18.00	34.00	XGE28LMED	GE28LMED	120-140	100
35	M45X2.0-6g	M42X2.0-6g	50.00	50.00	48.00	30.00	35.00	20.00	39.00	XGE35LMED	GE35LMED	170-190	100
42	M52X2.0-6g	M48X2.0-6g	55.00	60.00	52.00	36.00	42.00	22.00	42.00	XGE42LMED	GE42LMED	190-230	100

S SERIES

Tube O.D.	A THREAD	B THREAD	S1 Hex	S2 Hex	L	ØD DRILL	ØP	L3	L4	BodyPartNumber	AssemblyPartNumber	Torque N-m	Working pressure in Bar
6	M14X1.5-6g	M12X1.5-6g	17.00	17.00	32.00	4.00	6.00	14.00	28.00	XGE06SMED	GE06SMED	14-16	630
8	M16X1.5-6g	M14X1.5-6g	19.00	19.00	34.00	5.00	8.00	12.00	30.00	XGE08SMED	GE08SMED	25-28	630
10	M18X1.5-6g	M16X1.5-6g	22.00	22.00	34.50	7.00	10.00	12.00	31.00	XGE10SMED	GE10SMED	27-30	630
12	M20X1.5-6g	M18X1.5-6g	24.00	24.00	36.50	8.00	12.00	12.00	33.00	XGE12SMED	GE12SMED	43-54	630
14	M22X1.5-6g	M20X1.5-6g	27.00	27.00	41.00	10.00	14.00	14.00	37.00	XGE14SMED	GE14SMED	50-62	630
16	M24X1.5-6g	M22X1.5-6g	27.00	30.00	41.00	12.00	16.00	14.00	37.00	XGE16SMED	GE16SMED	60-75	400
20	M30X2.0-6g	M27X2.0-6g	32.00	36.00	47.00	16.00	20.00	16.00	42.00	XGE20SMED	GE20SMED	90-110	400
25	M36X2.0-6g	M33X2.0-6g	41.00	46.00	53.00	20.00	25.00	18.00	47.00	XGE25SMED	GE25SMED	125-145	400
30	M42X2.0-6g	M42X2.0-6g	50.00	50.00	57.00	25.00	30.00	20.00	50.00	XGE30SMED	GE30SMED	170-190	250
38	M52X2.0-6g	M48X2.0-6g	55.00	60.00	64.00	32.00	38.00	22.00	57.00	XGE38SMED	GE38SMED	200-245	250

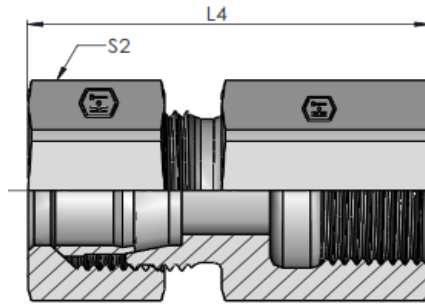
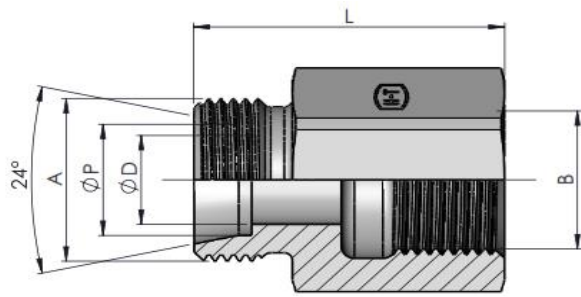
Material	Suffix surface and material	Example
Steel ,Zinc plated chrome (VI)-free		XGE06LMED
Steel ,Zinc nickel plated	ZiNi	XGE06LMED-ZiNi
Stainless Steel-SS316 Ti	SST	XGE06LMED-SST
Stainless Steel-SS316	SS316	XGE06LMED-SS
Stainless Steel-SS304	SS304	XGE06LMED-S



GAI-R - Parallel Female Coupling
L SERIES

Tube O.D.	A THREAD	B THREAD	S1 Hex	S2 Hex	L	ØD DRILL	ØP	L4	Body Part Number	Assembly Part Number	Torque N-m	Working pressure in Bar
6	M12X1.5-6g	G1/8"-28-BSPP-A	14.00	14.00	26.00	4.00	6.00	34.00	XGAI06LR	GAI06LR	13-15	250
8	M14X1.5-6g	G1/4"-19-BSPP-A	19.00	17.00	31.00	6.00	8.00	39.00	XGAI08LR	GAI08LR	15-18	250
10	M16X1.5-6g	G1/4"-19-BSPP-A	19.00	19.00	32.00	6.00	10.00	40.00	XGAI10LR	GAI10LR	25-28	250
12	M18X1.5-6g	G3/8"-19-BSPP-A	24.00	22.00	33.00	9.00	12.00	41.00	XGAI12LR	GAI12LR	27-30	250
15	M22X1.5-6g	G1/2"-14-BSPP-A	27.00	27.00	38.00	11.00	15.00	46.00	XGAI15LR	GAI15LR	50-60	250
18	M26X1.5-6g	G1/2"-14-BSPP-A	27.00	32.00	38.00	14.00	18.00	47.00	XGAI18LR	GAI18LR	60-75	160
22	M30X2.0-6g	G3/4"-14-BSPP-A	36.00	36.00	43.00	18.00	22.00	52.00	XGAI22LR	GAI22LR	85-105	160
28	M36X2.0-6g	G1"-11-BSPP-A	41.00	41.00	45.50	23.00	28.00	55.00	XGAI28LR	GAI28LR	120-140	100
35	M45X2.0-6g	G1-1/4"-11-BSPP-A	55.00	50.00	51.50	30.00	35.00	63.00	XGAI35LR	GAI35LR	170-190	100
42	M52X2.0-6g	G1-1/2"-11-BSPP-A	60.00	60.00	53.50	36.00	42.00	65.00	XGAI42LR	GAI42LR	190-230	100

S SERIES

Tube O.D.	A THREAD	B THREAD	S1 Hex	S2 Hex	L	ØD DRILL	ØP	L4	Body Part Number	Assembly Part Number	Torque N-m	Working pressure in Bar
6	M14X1.5-6g	G1/4"-19-BSPP-A	19.00	17.00	33.00	4.00	6.00	41.00	XGAI06SR	GAI06SR	14-16	630
8	M16X1.5-6g	G1/4"-19-BSPP-A	19.00	19.00	33.00	5.00	8.00	41.00	XGAI08SR	GAI08SR	25-28	630
10	M18X1.5-6g	G3/8"-19-BSPP-A	24.00	22.00	34.00	7.00	10.00	43.00	XGAI10SR	GAI10SR	27-30	630
12	M20X1.5-6g	G3/8"-19-BSPP-A	24.00	24.00	34.00	8.00	12.00	43.00	XGAI12SR	GAI12SR	43-54	630
16	M24X1.5-6g	G1/2"-14-BSPP-A	30.00	30.00	40.00	12.00	16.00	50.00	XGAI16SR	GAI16SR	60-75	400
20	M30X2.0-6g	G3/4"-14-BSPP-A	36.00	36.00	45.00	16.00	20.00	56.00	XGAI20SR	GAI20SR	90-110	400
25	M36X2.0-6g	G1"-11-BSPP-A	41.00	46.00	49.50	20.00	25.00	62.00	XGAI25SR	GAI25SR	125-145	400
30	M42X2.0-6g	G1-1/4"-11-BSPP-A	55.00	50.00	55.50	25.00	30.00	69.00	XGAI30SR	GAI30SR	170-190	250
38	M52X2.0-6g	G1-1/2"-11-BSPP-A	60.00	60.00	59.50	32.00	38.00	74.00	XGAI38SR	GAI38SR	200-245	250

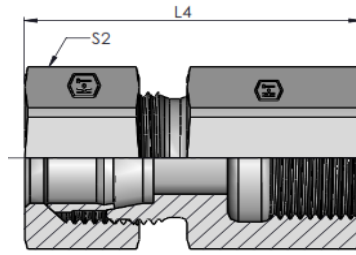
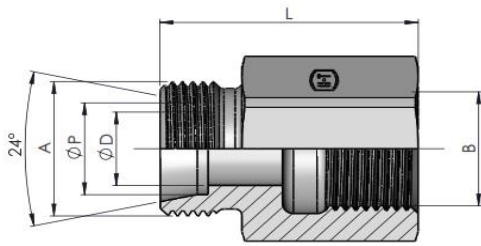
Material	Suffix surface and material	Example
Steel ,Zinc plated chrome (VI)-free		XGAI06LR
Steel ,Zinc nickel plated	ZiNi	XGAI06LR-ZiNi
Stainless Steel-SS316 Ti	SST	XGAI06LR-SST
Stainless Steel-SS316	SS316	XGAI06LR-SS
Stainless Steel-SS304	SS304	XGAI06LR-S



C-14

GAI-M - Parallel Female Coupling

L SERIES

Tube O.D.	A THREAD	B THREAD	S1 Hex	S2 Hex	L	ØD DRILL	ØP	L4	Body Part Number	Assembly Part Number	Torque N-m	Working pressure in Bar
6	M12X1.5-6g	M10X1.0-6H	14.00	14.00	26.50	4.00	6.00	34.00	XGAI06LM	GAI06LM	13-15	250
8	M14X1.5-6g	M12X1.5-6H	17.00	17.00	31.00	6.00	8.00	34.00	XGAI08LM	GAI08LM	15-18	250
10	M16X1.5-6g	M14X1.5-6H	19.00	19.00	32.00	6.00	10.00	40.00	XGAI10LM	GAI10LM	25-28	250
12	M18X1.5-6g	M16X1.5-6H	22.00	22.00	33.00	9.00	12.00	41.00	XGAI12LM	GAI12LM	27-30	250
15	M22X1.5-6g	M18X1.5-6H	24.00	27.00	35.00	11.00	15.00	43.00	XGAI15LM	GAI15LM	50-60	250
18	M26X1.5-6g	M22X1.5-6H	27.00	32.00	37.00	14.00	18.00	46.00	XGAI18LM	GAI18LM	60-75	160
22	M30X2.0-6g	M26X1.5-6H	30.00	36.00	42.00	18.00	22.00	51.00	XGAI22LM	GAI22LM	85-105	160
28	M36X2.0-6g	M33X2.0-6H	41.00	41.00	45.00	23.00	28.00	54.00	XGAI28LM	GAI28LM	120-140	100
35	M45X2.0-6g	M42X2.0-6H	50.00	50.00	51.00	30.00	35.00	62.00	XGAI35LM	GAI35LM	170-190	100
42	M52X2.0-6g	M48X2.0-6H	55.00	60.00	53.00	36.00	42.00	65.00	XGAI42LM	GAI42LM	190-230	100

S SERIES

Tube O.D.	A THREAD	B THREAD	S1 Hex	S2 Hex	L	ØD DRILL	ØP	L4	Body Part Number	Assembly Part Number	Torque N-m	Working pressure in Bar
6	M14X1.5-6g	M12X1.5-6H	17.00	17.00	33.00	4.00	6.00	41.00	XGAI06SM	GAI06SM	14-16	630
8	M16X1.5-6g	M14X1.5-6H	19.00	19.00	33.00	5.00	8.00	41.00	XGAI08SM	GAI08SM	25-28	630
10	M18X1.5-6g	M16X1.5-6H	22.00	22.00	34.00	7.00	10.00	43.00	XGAI10SM	GAI10SM	27-30	630
12	M20X1.5-6g	M18X1.5-6H	24.00	24.00	35.00	8.00	12.00	44.00	XGAI12SM	GAI12SM	43-54	630
16	M24X1.5-6g	M22X1.5-6H	30.00	30.00	39.00	12.00	16.00	49.00	XGAI16SM	GAI16SM	60-75	400
20	M30X2.0-6g	M27X2.0-6H	36.00	36.00	45.00	16.00	20.00	56.00	XGAI20SM	GAI20SM	90-110	400
25	M36X2.0-6g	M33X2.0-6H	41.00	46.00	49.00	20.00	25.00	61.00	XGAI25SM	GAI25SM	125-145	400
30	M42X2.0-6g	M42X2.0-6H	50.00	50.00	55.00	25.00	30.00	68.00	XGAI30SM	GAI30SM	170-190	250
38	M52X2.0-6g	M48X2.0-6H	55.00	60.00	59.00	32.00	38.00	74.00	XGAI38SM	GAI38SM	200-245	250

Material	Suffix surface and material	Example
Steel ,Zinc plated chrome (VI)-free		XGAI06LM
Steel ,Zinc nickel plated	ZiNi	XGAI06LM-ZiNi
Stainless Steel-SS316 Ti	SST	XGAI06LM-SST
Stainless Steel-SS316	SS316	XGAI06LM-SS
Stainless Steel-SS304	SS304	XGAI06LM-S

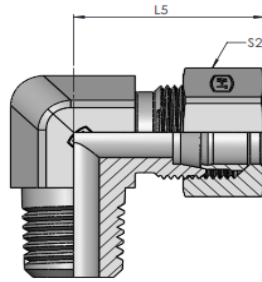
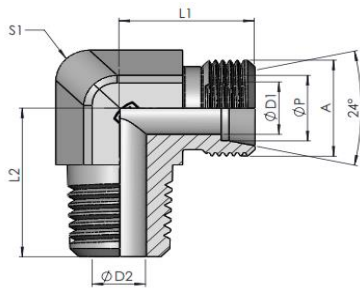

WE-R - Male Stud Elbow

L SERIES

Tube O.D.	A THREAD	B THREAD	S1 Hex	S2 Hex	L1	L2	ØD1 DRILL	ØD2 DRILL	ØP	L5	Body Part Number	Assembly Part Number	Torque N-m	Working pressure in Bar
6	M12X1.5-6g	R1/8"-28-BSPT-A	12.00	14.00	19.00	20.00	4.00	4.00	6.0	27.00	XWE06LR	WE06LR	13-15	250
8	M14X1.5-6g	R1/4"-19-BSPT-A	14.00	17.00	21.00	26.00	6.00	6.00	8.00	29.00	XWE08LR	WE08LR	15-18	250
10	M16X1.5-6g	R1/4"-19-BSPT-A	14.00	19.00	22.00	27.00	7.00	7.00	10.00	30.00	XWE10LR	WE10LR	25-28	250
12	M18X1.5-6g	R3/8"-19-BSPT-A	17.00	22.00	24.00	28.00	9.00	9.00	12.00	32.00	XWE12LR	WE12LR	27-30	250
15	M22X1.5-6g	R1/2"-14-BSPT-A	24.00	27.00	28.00	34.00	11.00	11.00	15.00	36.00	XWE15LR	WE15LR	50-60	250
18	M26X1.5-6g	R1/2"-14-BSPT-A	24.00	32.00	31.00	36.00	14.00	14.00	18.00	40.00	XWE18LR	WE18LR	60-75	160
22	M30X2.0-6g	G3/4"-14-BSPP-A	27.00	36.00	35.00	42.00	18.00	18.00	22.00	44.00	XWE22LR	WE22LR	85-105	160
28	M36X2.0-6g	G1"-11-BSPP-A	36.00	41.00	38.00	48.00	23.00	23.00	28.00	47.00	XWE28LR	WE28LR	120-140	100
35	M45X2.0-6g	G1-1/4"-11-BSPP-A	41.00	50.00	45.00	54.00	30.00	30.00	35.00	56.00	XWE35LR	WE35LR	170-190	100
42	M52X2.0-6g	G1-1/2"-11-BSPP-A	50.00	60.00	51.00	61.00	36.00	36.00	42.00	63.00	XWE42LR	WE42LR	190-230	100

S SERIES

Tube O.D.	A THREAD	B THREAD	S1 Hex	S2 Hex	L1	L2	ØD1 DRILL	ØD2 DRILL	ØP	L5	Body Part Number	Assembly Part Number	Torque N-m	Working pressure in Bar
6	M14X1.5-6g	R1/4"-19-BSPT-A	12.00	17.00	23.00	26.00	4.00	4.00	6.00	31.00	XWE06SR	WE06SR	14-16	630
8	M16X1.5-6g	R1/4"-19-BSPT-A	14.00	19.00	24.00	27.00	5.00	5.00	8.00	32.00	XWE08SR	WE08SR	25-28	630
10	M18X1.5-6g	R3/8"-19-BSPT-A	17.00	22.00	25.00	28.00	7.00	7.00	10.00	34.00	XWE10SR	WE10SR	27-30	630
12	M20X1.5-6g	R3/8"-19-BSPT-A	17.00	24.00	29.00	28.00	8.00	8.00	12.00	38.00	XWE12SR	WE12SR	43-54	630
16	M24X1.5-6g	R1/2"-14-BSPT-A	24.00	30.00	33.00	32.00	12.00	12.00	16.00	43.00	XWE16SR	WE16SR	60-75	400
20	M30X2.0-6g	G3/4"-14-BSPP-A	27.00	36.00	37.00	42.00	16.00	16.00	20.00	48.00	XWE20SR	WE20SR	90-110	400
25	M36X2.0-6g	G1"-11-BSPP-A	36.00	46.00	42.00	48.00	20.00	20.00	25.00	54.00	XWE25SR	WE25SR	125-145	400
30	M42X2.0-6g	G1-1/4"-11-BSPP-A	41.00	50.00	49.00	54.00	25.00	25.00	30.00	62.00	XWE30SR	WE30SR	170-190	250
38	M52X2.0-6g	G1-1/2"-11-BSPP-A	50.00	60.00	57.00	61.00	32.00	32.00	38.00	72.00	XWE38SR	WE38SR	200-245	250

Material	Suffix surface and material	Example
Steel ,Zinc plated chrome (VI)-free		XWE06LR
Steel ,Zinc nickel plated	ZiNi	XWE06LR-ZiNi
Stainless Steel-SS316 Ti	SST	XWE06LR-SST
Stainless Steel-SS316	SS316	XWE06LR-SS
Stainless Steel-SS304	SS304	XWE06LR-S

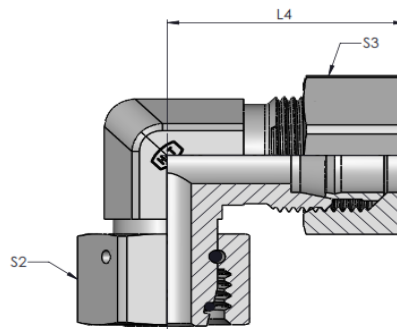
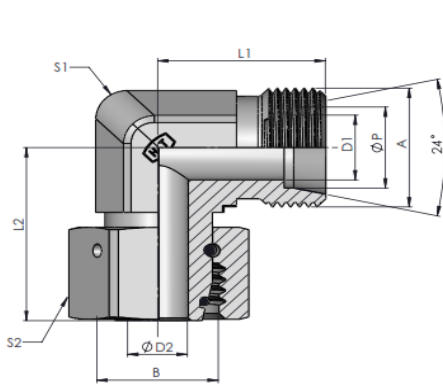

EW- Swivel Nut Elbow

L SERIES

Tube O.D.	A THREAD	B THREAD	S1 Hex	S2 Hex	S3 Hex	L1	L2	ØD1 DRILL	ØD2 DRILL	ØP	L4	Body Part Number	Assembly Part Number	Torque N-m	Working pressure in Bar
8	M14X1.5-6g	M14X1.5-6H	14.00	17.00	17.00	21.00	27.00	6.00	4.00	8.00	29.00	XEW08L	EW08L	15-18	250
10	M16X1.5-6g	M16X1.5-6H	14.00	19.00	19.00	22.00	28.50	8.00	6.00	10.00	30.00	XEW10L	EW10L	25-28	250
12	M18X1.5-6g	M18X1.5-6H	17.00	22.00	22.00	24.00	29.00	10.00	8.00	12.00	32.00	XEW12L	EW12L	27-30	250
15	M22X1.5-6g	M22X1.5-6H	19.00	27.00	27.00	28.00	32.00	12.00	10.00	15.00	36.00	XEW15L	EW15L	50-60	250
18	M26X1.5-6g	M26X1.5-6H	24.00	32.00	32.00	31.00	35.00	15.00	14.00	18.00	40.00	XEW18L	EW18L	60-75	160
22	M30X2.0-6g	M30X2.0-6H	27.00	36.00	36.00	35.00	38.00	19.00	18.00	22.00	44.00	XEW22L	EW22L	85-105	160
28	M36X2.0-6g	M36X2.0-6H	36.00	41.00	41.00	38.00	41.50	24.00	22.00	28.00	47.00	XEW28L	EW28L	120-140	100
35	M45X2.0-6g	M45X2.0-6H	41.00	50.00	50.00	45.00	51.00	30.00	28.00	35.00	56.00	XEW35L	EW35L	170-190	100
42	M52X2.0-6g	M52X2.0-6H	50.00	60.00	60.00	51.00	56.00	36.00	34.00	42.00	63.00	XEW42L	EW42L	190-230	100

S SERIES

Tube O.D.	A THREAD	B THREAD	S1 Hex	S2 Hex	S3 Hex	L1	L2	ØD1 DRILL	ØD2 DRILL	ØP	L4	Body Part Number	Assembly Part Number	Torque N-m	Working pressure in Bar
8	M16X1.5-6g	M16X1.5-6H	14.00	19.00	19.00	24.00	27.00	5.00	4.00	8.00	32.00	XEW08S	EW08S	25-28	630
10	M18X1.5-6g	M18X1.5-6H	17.00	22.00	22.00	25.00	29.50	7.00	6.00	10.00	34.00	XEW10S	EW10S	27-30	630
12	M20X1.5-6g	M20X1.5-6H	19.00	24.00	24.00	29.00	30.50	8.00	8.00	12.00	38.00	XEW12S	EW12S	43-54	630
16	M24X1.5-6g	M24X1.5-6H	24.00	30.00	30.00	33.00	36.00	12.00	11.00	16.00	43.00	XEW16S	EW16S	60-75	400
20	M30X2.0-6g	M30X2.0-6H	27.00	36.00	36.00	37.00	44.00	16.00	14.00	20.00	48.00	XEW20S	EW20S	90-110	400
25	M36X2.0-6g	M36X2.0-6H	36.00	46.00	46.00	42.00	49.50	20.00	18.00	25.00	54.00	XEW25S	EW25S	125-145	400
30	M42X2.0-6g	M42X2.0-6H	41.00	50.00	50.00	49.00	55.00	25.00	23.00	30.00	62.00	XEW30S	EW30S	170-190	250
38	M52X2.0-6g	M52X2.0-6H	50.00	60.00	60.00	57.00	63.00	32.00	30.00	38.00	72.00	XEW38S	EW38S	200-245	250

Material	Suffix surface and material	Example
Steel ,Zinc plated chrome (VI)-free		XEW08L
Steel ,Zinc nickel plated	ZiNi	XEW08L-ZiNi
Stainless Steel-SS316 Ti	SST	XEW08L-SST
Stainless Steel-SS316	SS316	XEW08L-SS
Stainless Steel-SS304	SS304	XEW08L-S

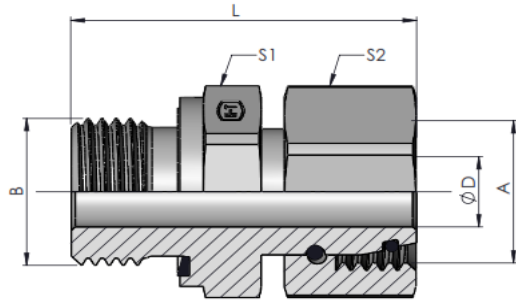

C-17

EGE-R-Swivel Connector

L SERIES

Tube O.D.	A THREAD	B THREAD	S1 Hex	S2 Hex	L	ØD DRILL	Body Part Number	Assembly Part Number	Torque N-m	Working pressure in Bar
8	M14X1.5-6H	G1/4"-19BSPP-A	19.00	17.00	39.50	4.00	XEGE08LRED	EGE08LRED	15-18	250
10	M16X1.5-6H	G1/4"-19BSPP-A	19.00	19.00	38.00	6.00	XEGE10LRED	EGE10LRED	25-28	250
12	M18X1.5-6H	G3/8"-19BSPP-A	22.00	22.00	44.50	8.00	XEGE12LRED	EGE12LRED	27-30	250
15	M22X1.5-6H	G1/2"-14BSPP-A	27.00	27.00	44.50	10.00	XEGE15LRED	EGE15LRED	50-60	250
18	M26X1.5-6H	G1/2"-14BSPP-A	27.00	32.00	43.50	13.00	XEGE18LRED	EGE18LRED	60-75	160
22	M30X2.0-6H	G3/4"-14BSPP-A	32.00	36.00	46.50	17.00	XEGE22LRED	EGE22LRED	85-105	160
28	M36X2.0-6H	G1"-11BSPP-A	41.00	41.00	51.00	22.00	XEGE28LRED	EGE28LRED	120-140	100
35	M45X2.0-6H	G1-1/4"-11BSPP-A	50.00	50.00	59.00	28.00	XEGE35LRED	EGE35LRED	170-190	100
42	M52X2.0-6H	G1-1/2"-11BSPP-A	55.00	60.00	64.50	34.00	XEGE42LRED	EGE42LRED	190-230	100

S SERIES

Tube O.D.	A THREAD	B THREAD	S1 Hex	S2 Hex	L	ØD DRILL	Body Part Number	Assembly Part Number	Torque N-m	Working pressure in Bar
8	M16X1.5-6H	G1/4"-19BSPP-A	19.00	19.00	39.50	4.00	XEGE08SRED	EGE08SRED	25-28	630
10	M18X1.5-6H	G3/8"-19BSPP-A	22.00	22.00	42.00	6.00	XEGE10SRED	EGE10SRED	27-30	630
12	M20X1.5-6H	G3/8"-19BSPP-A	22.00	24.00	44.00	8.00	XEGE12SRED	EGE12SRED	43-54	630
16	M24X1.5-6H	G1/2"-14BSPP-A	27.00	30.00	48.00	11.00	XEGE16SRED	EGE16SRED	60-75	400
20	M30X2.0-6H	G3/4"-14BSPP-A	32.00	36.00	55.50	14.00	XEGE20SRED	EGE20SRED	90-110	400
25	M36X2.0-6H	G1"-11BSPP-A	41.00	46.00	60.80	18.00	XEGE25SRED	EGE25SRED	125-145	400
30	M42X2.0-6H	G1-1/4"-11BSPP-A	50.00	50.00	64.50	23.00	XEGE30SRED	EGE30SRED	170-190	250
38	M52X2.0-6H	G1-1/2"-11BSPP-A	55.00	60.00	73.00	30.00	XEGE38SRED	EGE38SRED	200-245	250

Material	Suffix surface and material	Example
Steel ,Zinc plated chrome (VI)-free		XEGE08LRED
Steel ,Zinc nickel plated	ZiNi	XEGE08LRED-ZiNi
Stainless Steel-SS316 Ti	SST	XEGE08LRED-SST
Stainless Steel-SS316	SS316	XEGE08LRED-SS
Stainless Steel-SS304	SS304	XEGE08LRED-S

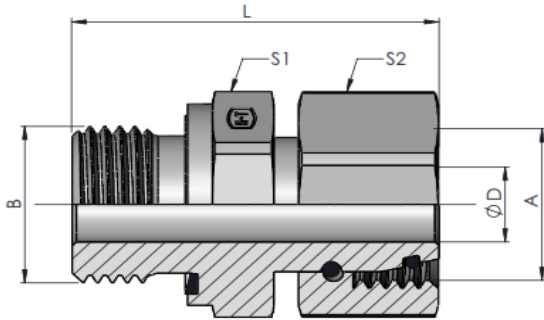

EGE-M-Swivel Connector

L SERIES

Tube O.D.	A THREAD	B THREAD	S1 Hex	S2 Hex	L	ØD DRILL	Body Part Number	Assembly Part Number	Torque N-m	Working pressure in Bar
8	M14X1.5-6H	M12X1.5-6g	17.00	17.00	38.50	4.00	XEGE08LMED	EGE08LMED	15-18	250
10	M16X1.5-6H	M14X1.5-6g	19.00	19.00	38.50	6.00	XEGE10LMED	EGE10LMED	25-28	250
12	M18X1.5-6H	M16X1.5-6g	22.00	22.00	41.00	7.50	XEGE12LMED	EGE12LMED	27-30	250
15	M22X1.5-6H	M18X1.5-6g	24.00	27.00	42.50	10.00	XEGE15LMED	EGE15LMED	50-60	250
18	M26X1.5-6H	M22X1.5-6g	27.00	32.00	44.20	14.00	XEGE18LMED	EGE18LMED	60-75	160
22	M30X2.0-6H	M26X1.5-6g	32.00	36.00	47.20	18.00	XEGE22LMED	EGE22LMED	85-105	160
28	M36X2.0-6H	M33X2.0-6g	41.00	41.00	52.00	22.00	XEGE28LMED	EGE28LMED	120-140	100
35	M45X2.0-6H	M42X2.0-6g	50.00	50.00	61.00	28.00	XEGE35LMED	EGE35LMED	170-190	100
42	M52X2.0-6H	M48X2.0-6g	50.00	60.00	66.30	36.00	XEGE42LMED	EGE42LMED	190-230	100

S SERIES

Tube O.D.	A THREAD	B THREAD	S1 Hex	S2 Hex	L	ØD DRILL	Body Part Number	Assembly Part Number	Torque N-m	Working pressure in Bar
8	M16X1.5-6H	M14X1.5-6g	19.00	19.00	40.20	4.00	XEGE08SMED	EGE08SMED	25-28	630
10	M18X1.5-6H	M16X1.5-6g	22.00	22.00	42.50	6.00	XEGE10SMED	EGE10SMED	27-30	630
12	M20X1.5-6H	M18X1.5-6g	24.00	24.00	44.70	8.00	XEGE12SMED	EGE12SMED	43-54	630
16	M24X1.5-6H	M22X1.5-6g	27.00	30.00	50.00	10.00	XEGE16LMED	EGE16SMED	60-75	400
20	M30X2.0-6H	M27X2.0-6g	32.00	36.00	58.00	14.00	XEGE20SMED	EGE20SMED	90-110	400
25	M36X2.0-6H	M33X2.0-6g	41.00	46.00	64.50	17.00	XEGE25LMED	EGE25SMED	125-145	400
30	M42X2.0-6H	M42X2.0-6g	50.00	50.00	69.50	22.00	XEGE30SMED	EGE30SMED	170-190	250
38	M52X2.0-6H	M48X2.0-6g	55.00	60.00	78.50	28.00	XEGE38LMED	EGE38SMED	200-245	250

Material	Suffix surface and material	Example
Steel ,Zinc plated chrome (VI)-free		XEGE08LMED
Steel ,Zinc nickel plated	ZiNi	XEGE08LMED-ZiNi
Stainless Steel-SS316 Ti	SST	XEGE08LMED-SST
Stainless Steel-SS316	SS316	XEGE08LMED-SS
Stainless Steel-SS304	SS304	XEGE08LMED-S

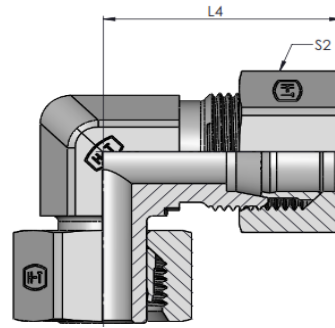
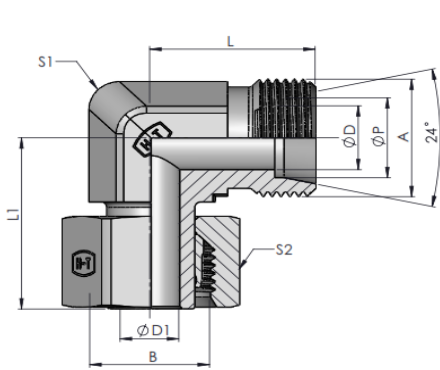

C-19

EVW-Swivel Elbow

L SERIES

Tube O.D.	A THREAD	B THREAD	S1 Hex	S2 Hex	L	L1	ØD DRILL	ØD1 DRILL	ØP	L4	Body Part Number	Assembly Part Number	Torque N-m	Working pressure in Bar
6	M12X1.5-6g	M12X1.5-6H	12.00	14.00	19.00	26.00	4.00	3.00	6.00	27.00	XEVW06L	EVW06L	13-15	250
8	M14X1.5-6g	M14X1.5-6H	12.00	17.00	21.00	27.00	6.00	4.00	8.00	29.00	XEVW08L	EVW08L	15-18	250
10	M16X1.5-6g	M16X1.5-6H	14.00	19.00	22.00	28.50	8.00	6.00	10.00	30.00	XEVW10L	EVW10L	25-28	250
12	M18X1.5-6g	M18X1.5-6H	17.00	22.00	24.00	29.00	10.00	7.00	12.00	32.00	XEVW12L	EVW12L	27-30	250
15	M22X1.5-6g	M22X1.5-6H	19.00	27.00	28.00	32.00	12.00	10.00	15.00	36.00	XEVW15L	EVW15L	50-60	250
18	M26X1.5-6g	M26X1.5-6H	24.00	32.00	31.00	35.00	15.00	13.00	18.00	40.00	XEVW18L	EVW18L	60-75	160
22	M30X2.0-6g	M30X2.0-6H	27.00	36.00	35.00	38.00	19.00	16.00	22.00	44.00	XEVW22L	EVW22L	85-105	160
28	M36X2.0-6g	M36X2.0-6H	36.00	41.00	38.00	41.50	24.00	22.00	28.00	47.00	XEVW28L	EVW28L	120-140	100
35	M45X2.0-6g	M45X2.0-6H	41.00	50.00	45.00	51.00	30.00	28.00	35.00	56.00	XEVW35L	EVW35L	170-190	100
42	M52X2.0-6g	M52X2.0-6H	50.00	60.00	51.00	56.00	36.00	34.00	42.00	63.00	XEVW42L	EVW42L	190-230	100

S SERIES

Tube O.D.	A THREAD	B THREAD	S1 Hex	S2 Hex	L	L1	ØD DRILL	ØD1 DRILL	ØP	L4	Body Part Number	Assembly Part Number	Torque N-m	Working pressure in Bar
6	M14X1.5-6g	M14X1.5-6H	12.00	17.00	23.00	27.00	4.00	3.00	6.00	31.00	XEVW06S	EVW06S	14-16	630
8	M16X1.5-6g	M16X1.5-6H	14.00	19.00	24.00	27.00	5.00	4.00	8.00	32.00	XEVW08S	EVW08S	25-28	630
10	M18X1.5-6g	M18X1.5-6H	17.00	22.00	25.00	29.50	7.00	6.00	10.00	34.00	XEVW10S	EVW10S	27-30	630
12	M20X1.5-6g	M20X1.5-6H	17.00	24.00	29.00	30.50	8.00	7.00	12.00	38.00	XEVW12S	EVW12S	43-54	630
14	M22X1.5-6g	M22X1.5-6H	19.00	27.00	30.00	34.50	10.00	9.00	14.00	40.00	XEVW14S	EVW14S	50-62	630
16	M24X1.5-6g	M24X1.5-6H	24.00	30.00	33.00	36.00	12.00	11.00	16.00	43.00	XEVW16S	EVW16S	60-75	400
20	M30X2.0-6g	M30X2.0-6H	27.00	36.00	37.00	44.00	16.00	15.00	20.00	48.00	XEVW20S	EVW20S	90-110	400
25	M36X2.0-6g	M36X2.0-6H	36.00	46.00	42.00	49.50	20.00	17.00	25.00	54.00	XEVW25S	EVW25S	125-145	400
30	M42X2.0-6g	M42X2.0-6H	41.00	50.00	49.00	55.00	25.00	22.00	30.00	62.00	XEVW30S	EVW30S	170-190	250
38	M52X2.0-6g	M52X2.0-6H	50.00	60.00	57.00	63.00	32.00	28.00	38.00	72.00	XEVW38S	EVW38S	200-245	250

Material	Suffix surface and material	Example
Steel ,Zinc plated chrome (VI)-free		XEVW06L
Steel ,Zinc nickel plated	ZiNi	XEVW06L-ZiNi
Stainless Steel-SS316 Ti	SST	XEVW06L-SST
Stainless Steel-SS316	SS316	XEVW06L-SS
Stainless Steel-SS304	SS304	XEVW06L-S

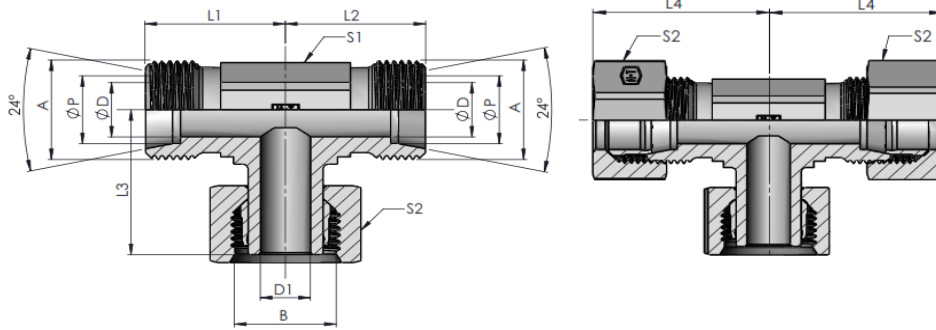

C-20

**EVT-Swivel Branch Tee
L SERIES**

Tube O.D.	A THREAD	B THREAD	S1 Hex	S2 Hex	L1 L2	L3	ØD DRILL	ØD1 DRILL	ØP	L4	Body Part Number	Assembly Part Number	Torque N-m	Working pressure in Bar
6	M12X1.5-6g	M12X1.5-6H	12.00	14.00	19.00	26.00	4.00	3.00	6.00	27.00	XEVT06L	EVT06L	13-15	250
8	M14X1.5-6g	M14X1.5-6H	14.00	17.00	21.00	27.00	6.00	4.00	8.00	29.00	XEVT08L	EVT08L	15-18	250
10	M16X1.5-6g	M16X1.5-6H	14.00	19.00	22.00	28.50	8.00	6.00	10.00	30.00	XEVT10L	EVT10L	25-28	250
12	M18X1.5-6g	M18X1.5-6H	17.00	22.00	24.00	29.00	10.00	7.00	12.00	32.00	XEVT12L	EVT12L	27-30	250
15	M22X1.5-6g	M22X1.5-6H	19.00	27.00	28.00	32.00	12.00	10.00	15.00	36.00	XEVT15L	EVT15L	50-60	250
18	M26X1.5-6g	M26X1.5-6H	24.00	32.00	31.00	35.00	15.00	13.00	18.00	40.00	XEVT18L	EVT18L	60-75	160
22	M30X2.0-6g	M30X2.0-6H	27.00	36.00	35.00	38.00	19.00	16.00	22.00	44.00	XEVT22L	EVT22L	85-105	160
28	M36X2.0-6g	M36X2.0-6H	36.00	41.00	38.00	41.50	24.00	22.00	28.00	47.00	XEVT28L	EVT28L	120-140	100
35	M45X2.0-6g	M45X2.0-6H	41.00	50.00	45.00	51.00	30.00	28.00	35.00	56.00	XEVT35L	EVT35L	170-190	100
42	M52X2.0-6g	M52X2.0-6H	50.00	60.00	51.00	56.00	36.00	34.00	42.00	63.00	XEVT42L	EVT42L	190-230	100

S SERIES

Tube O.D.	A THREAD	B THREAD	S1 Hex	S2 Hex	L1 L2	L3	ØD DRILL	ØD1 DRILL	ØP	L4	Body Part Number	Assembly Part Number	Torque N-m	Working pressure in Bar
6	M14X1.5-6g	M14X1.5-6H	14.00	17.00	23.00	27.00	4.00	3.00	6.00	31.00	XEVT06S	EVT06S	14-16	630
8	M16X1.5-6g	M16X1.5-6H	14.00	19.00	24.00	27.00	5.00	4.00	8.00	32.00	XEVT08S	EVT08S	25-28	630
10	M18X1.5-6g	M18X1.5-6H	17.00	22.00	25.00	29.50	7.00	6.00	10.00	34.00	XEVT10S	EVT10S	27-30	630
12	M20X1.5-6g	M20X1.5-6H	17.00	24.00	29.00	30.50	8.00	7.00	12.00	38.00	XEVT12S	EVT12S	43-54	630
14	M22X1.5-6g	M22X1.5-6H	24.00	27.00	30.00	34.50	10.00	9.00	14.00	40.00	XEVT14S	EVT14S	50-62	630
16	M24X1.5-6g	M24X1.5-6H	24.00	30.00	33.00	36.00	12.00	11.00	16.00	43.00	XEVT16S	EVT16S	60-75	400
20	M30X2.0-6g	M30X2.0-6H	27.00	36.00	37.00	44.00	16.00	15.00	20.00	48.00	XEVT20S	EVT20S	90-110	400
25	M36X2.0-6g	M36X2.0-6H	36.00	46.00	42.00	49.50	20.00	17.00	25.00	54.00	XEVT25S	EVT25S	125-145	400
30	M42X2.0-6g	M42X2.0-6H	41.00	50.00	49.00	55.00	25.00	22.00	30.00	62.00	XEVT30S	EVT30S	170-190	250
38	M52X2.0-6g	M52X2.0-6H	50.00	60.00	57.00	63.00	32.00	28.00	38.00	72.00	XEVT38S	EVT38S	200-245	250

Material	Suffix surface and material	Example
Steel ,Zinc plated chrome (VI)-free		XEVT06L
Steel ,Zinc nickel plated	ZiNi	XEVT06L-ZiNi
Stainless Steel-SS316 Ti	SST	XEVT06L-SST
Stainless Steel-SS316	SS316	XEVT06L-SS
Stainless Steel-SS304	SS304	XEVT06L-S

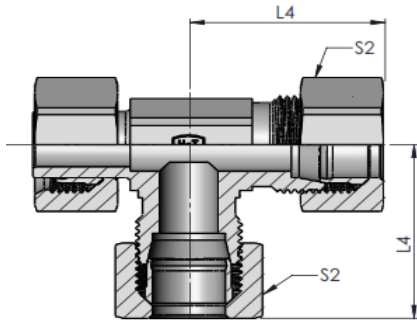
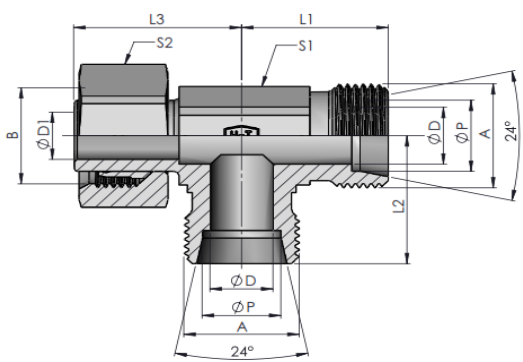

C-21

EVL-Swivel Run Tee

L SERIES

Tube O.D.	A THREAD	B THREAD	S1 Hex	S2 Hex	L1 L2	L3	ØD DRILL	ØD1 DRILL	ØP	L4	Body Part Number	Assembly Part Number	Torque N-m	Working pressure in Bar
6	M12X1.5-6g	M12X1.5-6H	12.00	14.00	19.00	26.00	4.00	3.00	6.00	27.00	XEVL06L	EVL06L	13-15	250
8	M14X1.5-6g	M14X1.5-6H	14.00	17.00	21.00	27.00	6.00	4.00	8.00	29.00	XEVL08L	EVL08L	15-18	250
10	M16X1.5-6g	M16X1.5-6H	14.00	19.00	22.00	28.50	8.00	6.00	10.00	30.00	XEVL10L	EVL10L	25-28	250
12	M18X1.5-6g	M18X1.5-6H	17.00	22.00	24.00	29.00	10.00	7.00	12.00	32.00	XEVL12L	EVL12L	27-30	250
15	M22X1.5-6g	M22X1.5-6H	19.00	27.00	28.00	32.00	12.00	10.00	15.00	36.00	XEVL15L	EVL15L	50-60	250
18	M26X1.5-6g	M26X1.5-6H	24.00	32.00	31.00	35.00	15.00	13.00	18.00	40.00	XEVL18L	EVL18L	60-75	160
22	M30X2.0-6g	M30X2.0-6H	27.00	36.00	35.00	38.00	19.00	16.00	22.00	44.00	XEVL22L	EVL22L	85-105	160
28	M36X2.0-6g	M36X2.0-6H	36.00	41.00	38.00	41.50	24.00	22.00	28.00	47.00	XEVL28L	EVL28L	120-140	100
35	M45X2.0-6g	M45X2.0-6H	41.00	50.00	45.00	51.00	30.00	28.00	35.00	56.00	XEVL35L	EVL35L	170-190	100
42	M52X2.0-6g	M52X2.0-6H	50.00	60.00	51.00	56.00	36.00	34.00	42.00	63.00	XEVL42L	EVL42L	190-230	100

S SERIES

Tube O.D.	A THREAD	B THREAD	S1 Hex	S2 Hex	L1 L2	L3	ØD DRILL	ØD1 DRILL	ØP	L4	Body Part Number	Assembly Part Number	Torque N-m	Working pressure in Bar
6	M14X1.5-6g	M14X1.5-6H	14.00	17.00	23.00	27.00	4.00	3.00	6.00	31.00	XEVL06S	EVL06S	14-16	630
8	M16X1.5-6g	M16X1.5-6H	14.00	19.00	24.00	27.00	5.00	4.00	8.00	32.00	XEVL08S	EVL08S	25-28	630
10	M18X1.5-6g	M18X1.5-6H	17.00	22.00	25.00	29.50	7.00	6.00	10.00	34.00	XEVL10S	EVL10S	27-30	630
12	M20X1.5-6g	M20X1.5-6H	17.00	24.00	29.00	30.50	8.00	7.00	12.00	38.00	XEVL12S	EVL12S	43-54	630
14	M22X1.5-6g	M22X1.5-6H	24.00	27.00	30.00	34.50	10.00	9.00	14.00	40.00	XEVL14S	EVL14S	50-62	630
16	M24X1.5-6g	M24X1.5-6H	24.00	30.00	33.00	36.00	12.00	11.00	16.00	43.00	XEVL16S	EVL16S	60-75	400
20	M30X2.0-6g	M30X2.0-6H	27.00	36.00	37.00	44.00	16.00	15.00	20.00	48.00	XEVL20S	EVL20S	90-110	400
25	M36X2.0-6g	M36X2.0-6H	36.00	46.00	42.00	49.50	20.00	17.00	25.00	54.00	XEVL25S	EVL25S	125-145	400
30	M42X2.0-6g	M42X2.0-6H	41.00	50.00	49.00	55.00	25.00	22.00	30.00	62.00	XEVL30S	EVL30S	170-190	250
38	M52X2.0-6g	M52X2.0-6H	50.00	60.00	57.00	63.00	32.00	28.00	38.00	72.00	XEVL38S	EVL38S	200-245	250

Material	Suffix surface and material	Example
Steel ,Zinc plated chrome (VI)-free		XEVL06L
Steel ,Zinc nickel plated	ZiNi	XEVL06L-ZiNi
Stainless Steel-SS316 Ti	SST	XEVL06L-SST
Stainless Steel-SS316	SS316	XEVL06L-SS
Stainless Steel-SS304	SS304	XEVL06L-S

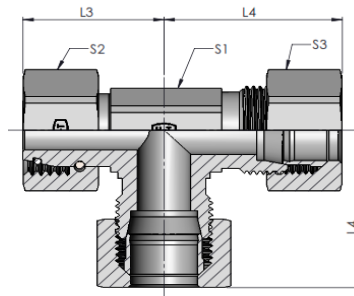
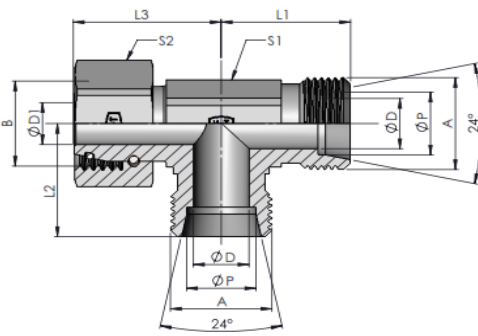

EL- Swivel Nut run tee

L SERIES

Tube O.D.	A THREAD	B THREAD	S1 Hex	S2 Hex	S3 Hex	L1 L2	L3	L4	ØD	ØD1	ØP	Body Part Number	Assembly Part Number	Torque N-m	Working pressure in Bar
8	M14X1.5-6g	M14X1.5-6H	14.00	17.00	17.00	21.00	27.00	29.00	6.00	4.00	8.00	XEL08L	EL08L	14-18	250
10	M16X1.5-6g	M16X1.5-6H	14.00	19.00	19.00	22.00	28.50	30.00	8.00	6.00	10.00	XEL10L	EL10L	23-27	250
12	M18X1.5-6g	M18X1.5-6H	17.00	22.00	22.00	24.00	29.00	32.00	10.00	8.00	12.00	XEL12L	EL12L	29-34	250
15	M22X1.5-6g	M22X1.5-6H	19.00	27.00	27.00	28.00	32.00	36.00	12.00	10.00	15.00	XEL15L	EL15L	38-42	250
18	M26X1.5-6g	M26X1.5-6H	24.00	32.00	32.00	31.00	35.00	40.00	15.00	14.00	18.00	XEL18L	EL18L	48-52	160
22	M30X2.0-6g	M30X2.0-6H	27.00	36.00	36.00	35.00	38.00	44.00	19.00	18.00	22.00	XEL22L	EL22L	75-80	160
28	M36X2.0-6g	M36X2.0-6H	36.00	41.00	41.00	38.00	41.50	47.00	24.00	22.00	28.00	XEL28L	EL28L	110-120	100
35	M45X2.0-6g	M45X2.0-6H	41.00	50.00	50.00	45.00	51.00	56.00	30.00	28.00	35.00	XEL35L	EL35L	150-160	100
42	M52X2.0-6g	M52X2.0-6H	50.00	60.00	60.00	51.00	56.00	63.00	36.00	34.00	42.00	XEL42L	EL42L	150-160	100

S SERIES

Tube O.D.	A THREAD	B THREAD	S1 Hex	S2 Hex	S3 Hex	L1 L2	L3	L4	ØD	ØD1	ØP	Body Part Number	Assembly Part Number	Torque N-m	Working pressure in Bar
8	M16X1.5-6g	M16X1.5-6H	14.00	19.00	19.00	24.00	27.00	32.00	5.0	4.00	8.00	XEL08S	EL08S	38-42	400
10	M18X1.5-6g	M18X1.5-6H	17.00	22.00	22.00	25.00	29.50	34.00	7.0	6.00	10.00	XEL10S	EL10S	47-53	400
12	M20X1.5-6g	M20X1.5-6H	17.00	24.00	24.00	29.00	30.50	38.00	8.0	8.00	12.00	XEL12S	EL12S	57-63	400
16	M24X1.5-6g	M24X1.5-6H	24.00	30.00	30.00	33.00	36.00	43.00	12.0	11.00	16.00	XEL16S	EL16S	80-90	400
20	M30X2.0-6g	M30X2.0-6H	27.00	36.00	36.00	37.00	44.00	48.00	16.0	14.00	20.00	XEL20S	EL20S	133-147	400
25	M36X2.0-6g	M36X2.0-6H	36.00	46.00	46.00	42.00	49.50	54.00	20.0	18.00	25.00	XEL25S	EL25S	180-200	400
30	M42X2.0-6g	M42X2.0-6H	41.00	50.00	50.00	49.00	55.0	62.00	25.0	23.00	30.00	XEL30S	EL30S	257-283	250
38	M52X2.0-6g	M52X2.0-6H	50.00	60.00	60.00	57.00	63.0	72.00	32.0	30.00	38.00	XEL38S	EL38S	257-283	250

Material	Suffix surface and material	Example
Steel ,Zinc plated chrome (VI)-free		XEL08L
Steel ,Zinc nickel plated	ZiNi	XEL08L-ZiNi
Stainless Steel-SS316 Ti	SST	XEL08L-SST
Stainless Steel-SS316	SS316	XEL08L-SS
Stainless Steel-SS304	SS304	XEL08L-S

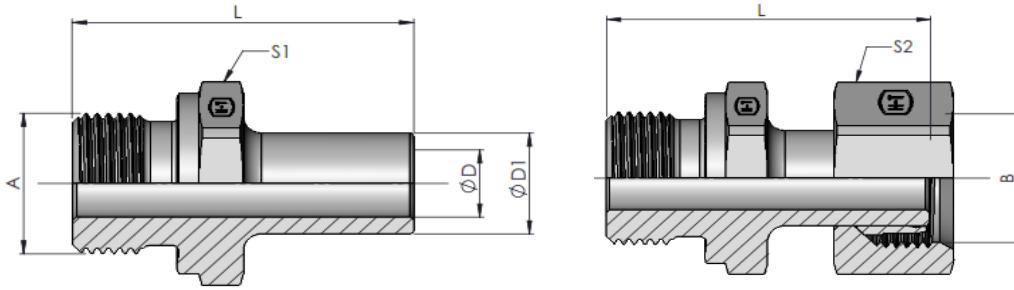

**EVGE-R-Stand Pipe Adaptor with nut and ferrule
L SERIES**

Tube O.D.	A THREAD	B THREAD	S1 Hex	S2 Hex	L	ØD DRILL	ØD1	Body Part Number	Assembly Part Number	Torque N-m	Working pressure in Bar
6	G1/8"-28-BSPP-A	M12X1.5-6H	14.00	14.00	32.50	3.00	6.00	XSP06LR	EVGE06LR	13-15	250
8	G1/4"-19-BSPP-A	M14X1.5-6H	19.00	17.00	41.50	4.00	8.00	XSP08LR	EVGE08LR	15-18	250
10	G1/4"-19-BSPP-A	M16X1.5-6H	19.00	19.00	39.50	6.00	10.00	XSP10LR	EVGE10LR	25-28	250
12	G3/8"-19-BSPP-A	M18X1.5-6H	22.00	22.00	46.00	7.00	12.00	XSP12LR	EVGE12LR	27-30	250
15	G1/2"-14-BSPP-A	M22X1.5-6H	27.00	27.00	46.00	10.00	15.00	XSP15LR	EVGE15LR	50-60	250
18	G1/2"-14-BSPP-A	M26X1.5-6H	27.00	32.00	45.50	13.00	18.00	XSP18LR	EVGE18LR	60-75	160
22	G3/4"-14-BSPP-A	M30X2.0-6H	32.00	36.00	48.50	16.00	22.00	XSP22LR	EVGE22LR	85-105	160
28	G1"-11-BSPP-A	M36X2.0-6H	41.00	41.00	53.00	22.00	28.00	XSP28LR	EVGE28LR	120-140	100
35	G1-1/4"-11-BSPP-A	M45X2.0-6H	50.00	50.00	62.50	28.00	35.00	XSP35LR	EVGE35LR	170-190	100
42	G1-1/2"-11-BSPP-A	M52X2.0-6H	55.00	60.00	68.50	34.00	42.00	XSP42LR	EVGE42LR	190-230	100

S SERIES

Tube O.D.	A THREAD	B THREAD	S1 Hex	S2 Hex	L	ØD DRILL	ØD1	Body Part Number	Assembly Part Number	Torque N-m	Working pressure in Bar
6	G1/4"-19-BSPP-A	M14X1.5-6H	19.00	17.00	39.00	3.00	6.00	XSP06SR	EVGE06SR	14-16	630
8	G1/4"-19-BSPP-A	M16X1.5-6H	19.00	19.00	41.50	4.00	8.00	XSP08SR	EVGE08SR	25-28	630
10	G3/8"-19-BSPP-A	M18X1.5-6H	22.00	22.00	44.00	6.00	10.00	XSP10SR	EVGE10SR	27-30	630
12	G3/8"-19-BSPP-A	M20X1.5-6H	22.00	24.00	46.00	7.00	12.00	XSP12SR	EVGE12SR	43-54	630
14	G1/2"-14-BSPP-A	M22X1.5-6H	27.00	27.00	50.50	9.00	14.00	XSP14SR	EVGE14SR	50-62	630
16	G1/2"-14-BSPP-A	M24X1.5-6H	27.00	30.00	51.00	11.00	16.00	XSP16SR	EVGE16SR	60-75	400
20	G3/4"-14-BSPP-A	M30X2.0-6H	32.00	36.00	59.00	15.00	20.00	XSP20SR	EVGE20SR	90-110	400
25	G1"-11-BSPP-A	M36X2.0-6H	41.00	46.00	66.00	17.00	25.00	XSP25SR	EVGE25SR	125-145	400
30	G1-1/4"-11-BSPP-A	M42X2.0-6H	50.00	50.00	71.00	22.00	30.00	XSP30SR	EVGE30SR	170-190	250
38	G1-1/2"-11-BSPP-A	M52X2.0-6H	55.00	60.00	82.00	28.00	38.00	XSP38SR	EVGE38SR	200-245	250

Material	Suffix surface and material	Example
Steel ,Zinc plated chrome (VI)-free		XSP06LR
Steel ,Zinc nickel plated	ZiNi	XSP06LR-ZiNi
Stainless Steel-SS316 Ti	SST	XSP06LR-SST
Stainless Steel-SS316	SS316	XSP06LR-SS
Stainless Steel-SS304	SS304	XSP06LR-S

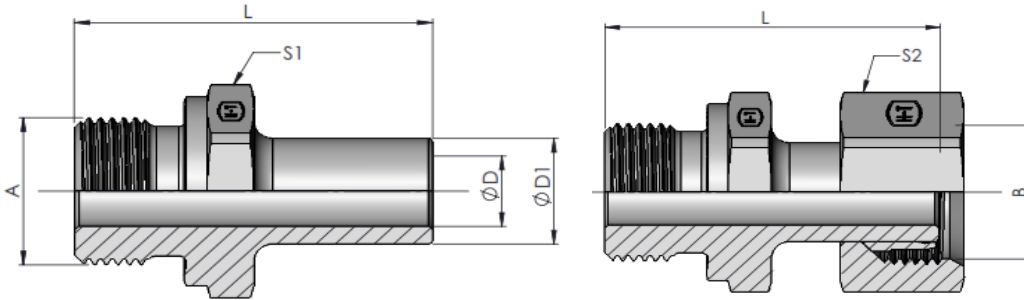

EVGE-M-Stand Pipe Adaptor with nut and ferrule

L SERIES

Tube O.D.	A THREAD	B THREAD	S1 Hex	S2 Hex	L	ØD DRILL	ØD1	Body Part Number	Assembly Part Number	Torque N-m	Working pressure in Bar
6	M10X1.5-6g	M12X1.5-6H	14.00	14.00	32.50	4.00	6.00	XSP06LM	EVGE06LM	13-15	250
8	M12X1.5-6g	M14X1.5-6H	17.00	17.00	38.50	6.00	8.00	XSP08LM	EVGE08LM	15-18	250
10	M14X1.5-6g	M16X1.5-6H	19.00	19.00	39.50	7.00	10.00	XSP10LM	EVGE10LM	25-28	250
12	M16X1.5-6g	M18X1.5-6H	22.00	22.00	41.50	9.00	12.00	XSP12LM	EVGE12LM	27-30	250
15	M18X1.5-6g	M22X1.5-6H	24.00	27.00	43.50	11.00	15.00	XSP15LM	EVGE15LM	50-60	250
18	M22X1.5-6g	M26X1.5-6H	27.00	32.00	45.50	18.00	18.00	XSP18LM	EVGE18LM	60-75	160
22	M26X1.5-6g	M30X2.0-6H	32.00	36.00	48.50	18.00	22.00	XSP22LM	EVGE22LM	85-105	160
28	M33X2.0-6g	M36X2.0-6H	41.00	41.00	53.00	23.00	28.00	XSP28LM	EVGE28LM	120-140	100
35	M42X2.0-6g	M45X2.0-6H	50.00	50.00	62.50	30.00	35.00	XSP35LM	EVGE35LM	170-190	100
42	M48X2.0-6g	M52X2.0-6H	55.00	60.00	68.20	36.00	42.00	XSP42LM	EVGE42LM	190-230	100

S SERIES

Tube O.D.	A THREAD	B THREAD	S1 Hex	S2 Hex	L	ØD DRILL	ØD1	Body Part Number	Assembly Part Number	Torque N-m	Working pressure in Bar
6	M12X1.5-6g	M14X1.5-6H	17.00	17.00	39.00	4.00	6.00	XSP06SM	EVGE06SM	14-16	630
8	M14X1.5-6g	M16X1.5-6H	19.00	19.00	41.50	5.00	8.00	XSP08SM	EVGE08SM	25-28	630
10	M16X1.5-6g	M18X1.5-6H	22.00	22.00	44.00	7.00	10.00	XSP10SM	EVGE10SM	27-30	630
12	M18X1.5-6g	M20X1.5-6H	24.00	24.00	46.00	8.00	12.00	XSP12SM	EVGE12SM	43-54	630
14	M20X1.5-6g	M22X1.5-6H	27.00	27.00	50.00	10.00	14.00	XSP14SM	EVGE14SM	50-62	630
16	M22X1.5-6g	M24X1.5-6H	27.00	30.00	51.00	12.00	16.00	XSP16SM	EVGE16SM	60-75	400
20	M27X2.0-6g	M30X2.0-6H	32.00	36.00	59.00	16.00	20.00	XSP20SM	EVGE20SM	90-110	400
25	M33X2.0-6g	M36X2.0-6H	41.00	46.00	66.00	20.00	25.00	XSP25SM	EVGE25SM	125-145	400
30	M42X2.0-6g	M42X2.0-6H	50.00	50.00	71.00	25.00	30.00	XSP30SM	EVGE30SM	170-190	250
38	M48X2.0-6g	M52X2.0-6H	55.00	60.00	82.00	32.00	38.00	XSP38SM	EVGE38SM	200-245	250

Material	Suffix surface and material	Example
Steel ,Zinc plated chrome (VI)-free		XSP06LM
Steel ,Zinc nickel plated	ZiNi	XSP06LM-ZiNi
Stainless Steel-SS316 Ti	SST	XSP06LM-SST
Stainless Steel-SS316	SS316	XSP06LM-SS
Stainless Steel-SS304	SS304	XSP06LM-S

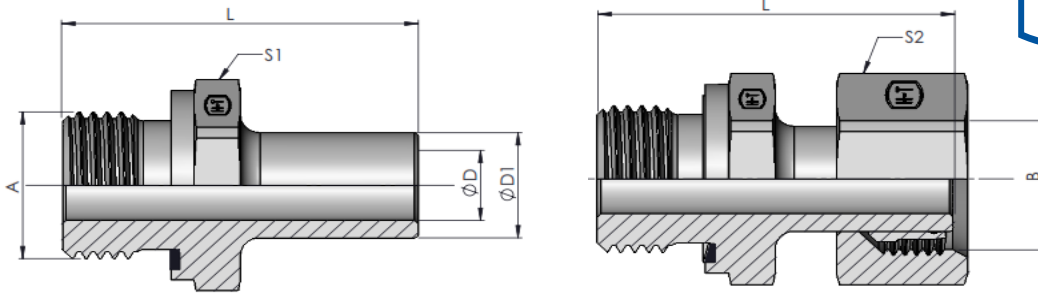

EVGE-R-ED -Stand Pipe Adaptor with nut and ferrule
L SERIES

Tube O.D.	A THREAD	B THREAD	S1 Hex	S2 Hex	L	ØD DRILL	ØD1	Body Part Number	Assembly Part Number	Torque N-m	Working pressure in Bar
6	G1/8"-28-BSPP-A	M12X1.5-6H	14.00	14.00	32.50	3.00	6.00	XSP06LRED	EVGE06LRED	13-15	250
8	G1/4"-19-BSPP-A	M14X1.5-6H	19.00	17.00	41.50	4.00	8.00	XSP08LRED	EVGE08LRED	15-18	250
10	G1/4"-19-BSPP-A	M16X1.5-6H	19.00	19.00	39.50	6.00	10.00	XSP10LRED	EVGE10LRED	25-28	250
12	G3/8"-19-BSPP-A	M18X1.5-6H	22.00	22.00	46.00	7.00	12.00	XSP12LRED	EVGE12LRED	27-30	250
15	G1/2"-14-BSPP-A	M22X1.5-6H	27.00	27.00	46.00	10.00	15.00	XSP15LRED	EVGE15LRED	50-60	250
18	G1/2"-14-BSPP-A	M26X1.5-6H	27.00	32.00	45.50	13.00	18.00	XSP18LRED	EVGE18LRED	60-75	160
22	G3/4"-14-BSPP-A	M30X2.0-6H	32.00	36.00	48.50	16.00	22.00	XSP22LRED	EVGE22LRED	85-105	160
28	G1"-11-BSPP-A	M36X2.0-6H	41.00	41.00	53.00	22.00	28.00	XSP28LRED	EVGE28LRED	120-140	100
35	G1-1/4"-11-BSPP-A	M45X2.0-6H	50.00	50.00	62.50	28.00	35.00	XSP35LRED	EVGE35LRED	170-190	100
42	G1-1/2"-11-BSPP-A	M52X2.0-6H	55.00	60.00	68.50	34.00	42.00	XSP42LRED	EVGE42LRED	190-230	100

S SERIES

Tube O.D.	A THREAD	B THREAD	S1 Hex	S2 Hex	L	ØD DRILL	ØD1	Body Part Number	Assembly Part Number	Torque N-m	Working pressure in Bar
6	G1/4"-19-BSPP-A	M14X1.5-6H	19.00	17.00	39.00	3.00	6.00	XSP06SRED	EVGE06SRED	14-16	630
8	G1/4"-19-BSPP-A	M16X1.5-6H	19.00	19.00	41.50	4.00	8.00	XSP08SRED	EVGE08SRED	25-28	630
10	G3/8"-19-BSPP-A	M18X1.5-6H	22.00	22.00	44.00	6.00	10.00	XSP10SRED	EVGE10SRED	27-30	630
12	G3/8"-19-BSPP-A	M20X1.5-6H	22.00	24.00	46.00	7.00	12.00	XSP12SRED	EVGE12SRED	43-54	630
14	G1/2"-14-BSPP-A	M22X1.5-6H	27.00	27.00	50.50	9.00	14.00	XSP14SRED	EVGE14SRED	50-62	630
16	G1/2"-14-BSPP-A	M24X1.5-6H	27.00	30.00	51.00	11.00	16.00	XSP16SRED	EVGE16SRED	60-75	400
20	G3/4"-14-BSPP-A	M30X2.0-6H	32.00	36.00	59.00	15.00	20.00	XSP20SRED	EVGE20SRED	90-110	400
25	G1"-11-BSPP-A	M36X2.0-6H	41.00	46.00	66.00	17.00	25.00	XSP25SRED	EVGE25SRED	125-145	400
30	G1-1/4"-11-BSPP-A	M42X2.0-6H	50.00	50.00	71.00	22.00	30.00	XSP30SRED	EVGE30SRED	170-190	250
38	G1-1/2"-11-BSPP-A	M52X2.0-6H	55.00	60.00	82.00	28.00	38.00	XSP38SRED	EVGE38SRED	200-245	250

Material	Suffix surface and material	Example
Steel ,Zinc plated chrome (VI)-free		XSP06LRED
Steel ,Zinc nickel plated	ZiNi	XSP06LRED-ZiNi
Stainless Steel-SS316 Ti	SST	XSP06LRED-SST
Stainless Steel-SS316	SS316	XSP06LRED-SS
Stainless Steel-SS304	SS304	XSP06LRED-S

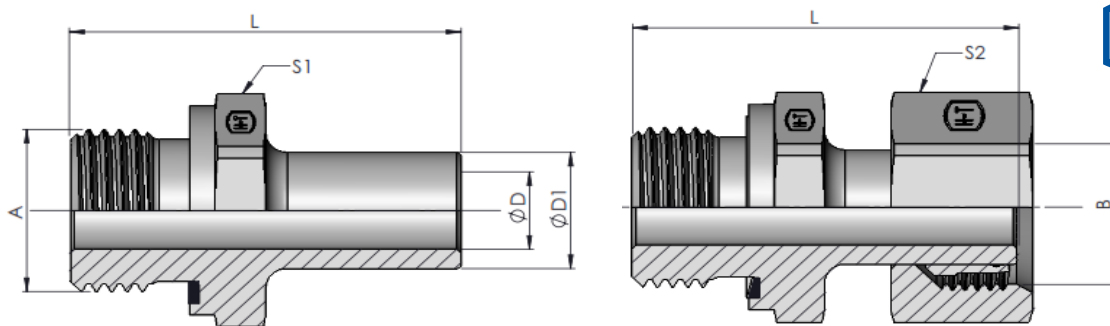

EVGE-M-ED Stand Pipe Adaptor with nut and ferrule

L SERIES

Tube O.D.	A THREAD	B THREAD	S1 Hex	S2 Hex	L	ØD DRILL	ØD1	Body Part Number	Assembly Part Number	Torque m	Working pressure in Bar
6	M10X1.5-6g	M12X1.5-6H	14.00	14.00	32.50	4.00	6.00	XSP 6-LMED	SP 6-LMED	13-15	250
8	M12X1.5-6g	M14X1.5-6H	17.00	17.00	38.50	6.00	8.00	XSP 8-LMED	SP 8-LMED	15-18	250
10	M14X1.5-6g	M16X1.5-6H	19.00	19.00	39.50	7.00	10.00	XSP 10-LMED	SP 10-LMED	25-28	250
12	M16X1.5-6g	M18X1.5-6H	22.00	22.00	41.50	9.00	12.00	XSP 12-LMED	SP 12-LMED	27-30	250
15	M18X1.5-6g	M22X1.5-6H	24.00	27.00	43.50	11.00	15.00	XSP 15-LMED	SP 15-LMED	50-60	250
18	M22X1.5-6g	M26X1.5-6H	27.00	32.00	45.50	18.00	18.00	XSP 18-LMED	SP 18-LMED	60-75	160
22	M26X1.5-6g	M30X2.0-6H	32.00	36.00	48.50	18.00	22.00	XSP 22-LMED	SP 22-LMED	85-105	160
28	M33X2.0-6g	M36X2.0-6H	41.00	41.00	53.00	23.00	28.00	XSP 28-LMED	SP 28-LMED	120-140	100
35	M42X2.0-6g	M45X2.0-6H	50.00	50.00	62.50	30.00	35.00	XSP 35-LMED	SP 35-LMED	170-190	100
42	M48X2.0-6g	M52X2.0-6H	55.00	60.00	68.50	36.00	42.00	XSP 42-LMED	SP 42-LMED	190-230	100

S SERIES

Tube O.D.	A THREAD	B THREAD	S1 Hex	S2 Hex	L	ØD DRILL	ØD1	Body Part Number	Assembly Part Number	Torque N-m	Working pressure in Bar
6	M12X1.5-6g	M14X1.5-6H	17.00	17.00	39.00	4.00	6.00	XSP 6-SMED	SP 6-SMED	14-16	630
8	M14X1.5-6g	M16X1.5-6H	19.00	19.00	41.50	5.00	8.00	XSP 8-SMED	SP 8-SMED	25-28	630
10	M16X1.5-6g	M18X1.5-6H	22.00	22.00	44.00	7.00	10.00	XSP 10-SMED	SP 10-SMED	27-30	630
12	M18X1.5-6g	M20X1.5-6H	24.00	24.00	46.00	8.00	12.00	XSP 12-SMED	SP 12-SMED	43-54	630
14	M20X1.5-6g	M22X1.5-6H	27.00	27.00	50.00	10.00	14.00	XSP 14-SMED	SP 14-SMED	50-62	630
16	M22X1.5-6g	M24X1.5-6H	27.00	30.00	51.00	12.00	16.00	XSP 16-SMED	SP 16-SMED	60-75	400
20	M27X2.0-6g	M30X2.0-6H	32.00	36.00	59.00	16.00	20.00	XSP 20-SMED	SP 20-SMED	90-110	400
25	M33X2.0-6g	M36X2.0-6H	41.00	46.00	66.00	20.00	25.00	XSP 25-SMED	SP 25-SMED	125-145	400
30	M42X2.0-6g	M42X2.0-6H	50.00	50.00	71.00	25.00	30.00	XSP 30-SMED	SP 30-SMED	170-190	250
38	M48X2.0-6g	M52X2.0-6H	55.00	60.00	82.00	32.00	38.00	XSP 38-SMED	SP 38-SMED	200-245	250

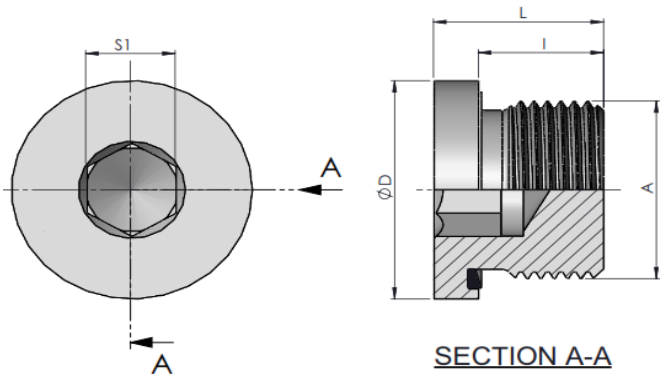

C-28

VSTI-R-Hollow Hex Plug

A THREAD	L LENGTH	I	ØD	S1 A/F Hex	Part Number	Torque N-m	Working pressure in Bar
G1/8"-28-BSPP-A	12.00	8.00	14.00	5.00	VSTIR1-8" BSPED	20-22	400
G1/4"-19-BSPP-A	17.00	12.00	19.00	6.00	VSTIR1-4" BSPED	60-66	400
G3/8"-19-BSPP-A	17.00	12.00	22.00	8.00	VSTIR3-8" BSPED	90-99	400
G1/2"-14-BSPP-A	19.00	14.00	27.00	10.00	VSTIR1-2" BSPED	130-143	400
G3/4"-14-BSPP-A	21.00	16.00	32.00	12.00	VSTIR3-4" BSPED	200-220	400
G1"-11-BSPP-A	22.50	16.00	40.00	17.00	VSTIR1" BSPED	380-418	400
G1-1/4"-11-BSPP-A	22.50	16.00	50.00	22.00	VSTIR1-1-4" BSPED	500-550	250
G1-1/2"-11-BSPP-A	22.50	16.00	55.00	24.00	VSTIR1-1-2" BSPED	600-660	250

Material	Suffix surface and material	Example
Steel ,Zinc plated chrome (VI)-free		VSTIR1-8" BSPED
Steel ,Zinc nickel plated	ZiNi	VSTIR1-8" BSPED-ZiNi
Stainless Steel-SS316 Ti	SST	VSTIR1-8" BSPED-SST
Stainless Steel-SS316	SS316	VSTIR1-8" BSPED-SS
Stainless Steel-SS304	SS304	VSTIR1-8" BSPED-S

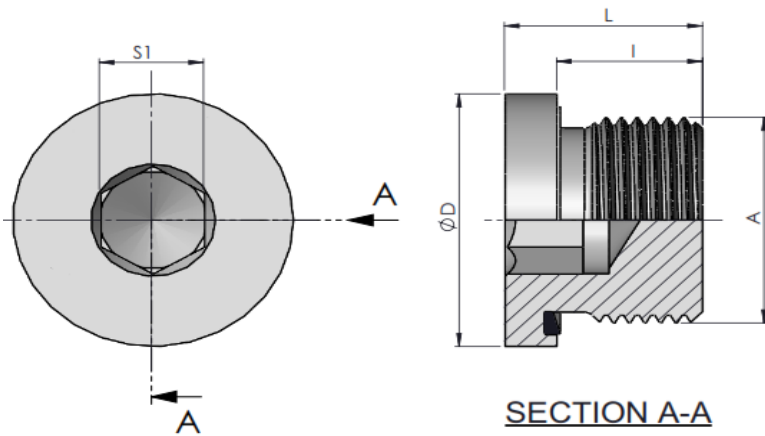

C-29

VSTI-M-Hollow Hex Plug

A THREAD	L LENGTH	I	ØD	S1 A/F Hex	Part Number	Torque N-m	Working pressure in Bar
M10X1.0-6g	12.00	8.00	14.00	5.00	VSTI-M10X1.0ED	20-22	400
M12X1.5-6g	17.00	12.00	17.00	6.00	VSTI-M12X1.5ED	45-49.5	400
M14X1.5-6g	17.00	12.00	19.00	6.00	VSTI-M14X1.5ED	60-66	400
M16X1.5-6g	17.00	12.00	22.00	8.00	VSTI-M16X1.5ED	80-88	400
M18X1.5-6g	17.00	12.00	24.00	8.00	VSTI-M18X1.5ED	100-110	400
M20X1.5-6g	19.00	14.00	26.00	10.00	VSTI-M20X1.5ED	140-154	400
M22X1.5-6g	19.00	14.00	27.00	10.00	VSTI-M22X1.5ED	150-165	400
M26X1.5-6g	21.00	16.00	32.00	12.00	VSTI-M26X1.5ED	200-220	400
M27X2.0-6g	21.00	16.00	32.00	12.00	VSTI-M27X2.0ED	200-220	400
M33X2.0-6g	22.50	16.00	40.00	17.00	VSTI-M33X2.0ED	380-418	400
M42X2.0-6g	22.50	16.00	50.00	22.00	VSTI-M42X2.0ED	500-550	250
M48X2.0-6g	22.50	16.00	55.00	24.00	VSTI-M48X2.0ED	600-660	250

Material	Suffix surface and material	Example
Steel ,Zinc plated chrome (VI)-free		VSTI-M10X1.0ED
Steel ,Zinc nickel plated	ZiNi	VSTIR1-8"BSPED-ZiNi
Stainless Steel-SS316 Ti	SST	VSTIR1-8"BSPED-SST
Stainless Steel-SS316	SS316	VSTIR1-8"BSPED-SS
Stainless Steel-SS304	SS304	VSTIR1-8"BSPED-S



C-30

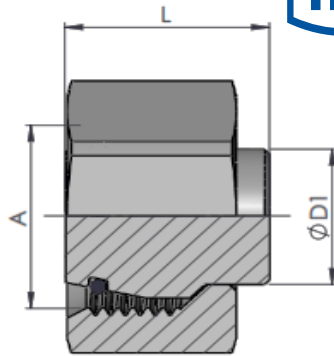
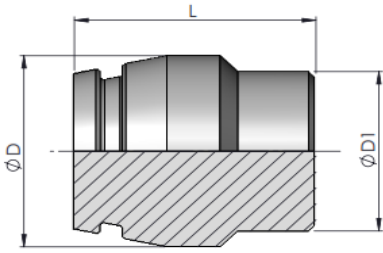

**VKA-Cap
L SERIES**

Tube O.D.	L LENGTH	ØD1	ØD	Body Part Number	Assembly Part Number	Torque N-m	Working pressure in Bar
6	18.50	6.00	9.90	XVKA06L	VKA06L	13-15	250
8	18.50	8.00	11.90	XVKA08L	VKA08L	15-18	250
10	20.00	10.00	13.00	XVKA10L	VKA10L	25-28	250
12	20.50	12.00	15.00	XVKA12L	VKA12L	27-30	250
15	20.50	15.00	18.00	XVKA15L	VKA15L	50-60	250
18	22.50	18.00	21.70	XVKA18L	VKA18L	60-75	160
22	25.00	22.00	25.70	XVKA22L	VKA22L	85-105	160
28	25.50	28.00	31.50	XVKA28L	VKA28L	120-140	100
35	30.00	35.00	39.50	XVKA35L	VKA35L	170-190	100
42	30.00	42.00	47.00	XVKA42L	VKA42L	190-230	100

S SERIES

Tube O.D.	L LENGTH	ØD1	ØD2	Body Part Number	Assembly Part Number	Torque N-m	Working pressure in Bar
6	18.50	6.00	9.90	XVKA06S	VKA06S	14-16	630
8	18.50	8.00	11.90	XVKA08S	VKA08S	25-28	630
10	20.00	10.00	13.00	XVKA10S	VKA10S	27-30	630
12	20.50	12.00	15.00	XVKA12S	VKA12S	43-54	630
14	22.50	14.00	17.00	XVKA14S	VKA14S	50-62	630
16	23.50	16.00	19.00	XVKA16S	VKA16S	60-75	400
20	28.50	20.00	24.00	XVKA20S	VKA20S	90-110	400
25	29.00	25.00	29.50	XVKA25S	VKA25S	125-145	400
30	30.50	30.00	34.50	XVKA30S	VKA30S	170-190	250
38	33.00	38.00	43.00	XVKA38S	VKA38S	200-245	250

Material	Suffix surface and material	Example
Steel ,Zinc plated chrome (VI)-free		XVKA06L
Steel ,Zinc nickel plated	ZiNi	XVKA06L-ZiNi
Stainless Steel-SS316 Ti	SST	XVKA06L-SST
Stainless Steel-SS316	SS316	XVKA06L-SS
Stainless Steel-SS304	SS304	XVKA06L-S

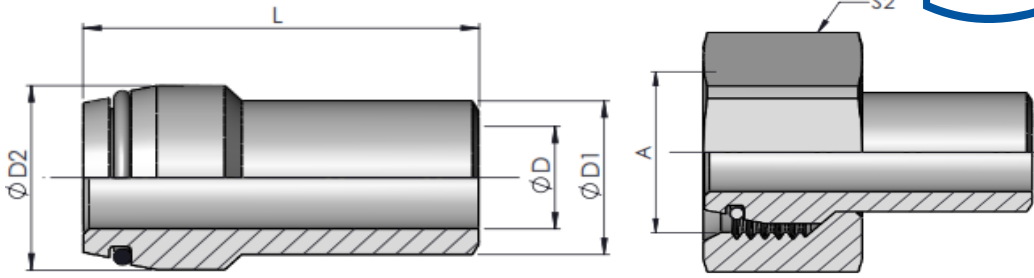

**VKA-Cap
L SERIES**

Tube O.D.	ØD2	L LENGTH	ØD1	ØD	A THREAD	S2 Hex	Body Part Number	Assembly Part Number	Torque N-m	Working pressure in Bar
6	9.20	31.50	6.00	3.00	M12X1.5-6H	14.00	XWN06L	WN06L	13-15	250
8	11.20	31.50	8.00	5.00	M14X1.5-6H	17.00	XWN08L	WN08L	15-18	250
10	14.00	32.50	10.00	7.00	M16X1.5-6H	19.00	XWN10L	WN10L	25-28	250
12	16.00	32.50	12.00	8.00	M18X1.5-6H	22.00	XWN12L	WN12L	27-30	250
15	18.20	34.50	15.00	10.00	M22X1.5-6H	27.00	XWN15L	WN15L	50-60	250
18	21.50	36.50	18.00	13.00	M26X1.5-6H	32.00	XWN18L	WN18L	60-75	160
22	25.70	38.00	22.00	17.00	M30X2.0-6H	36.00	XWN22L	WN22L	85-105	160
28	31.50	42.50	28.00	23.00	M36X2.0-6H	41.00	XWN28L	WN28L	120-140	100
35	40.00	49.50	35.00	29.00	M45X2.0-6H	50.00	XWN35L	WN35L	170-190	100
42	47.50	49.00	42.00	36.00	M52X2.0-6H	60.00	XWN42L	WN42L	190-230	100

S SERIES

Tube O.D.	ØD2	L LENGTH	ØD1	ØD	A THREAD	S2 Hex	Body Part Number	Assembly Part Number	Torque N-m	Working pressure in Bar
6	9.90	31.50	6.00	3.00	M14X1.5-6H	17.00	XWN06S	WN06S	14-16	630
8	11.90	31.50	8.00	5.00	M16X1.5-6H	19.00	XWN08S	WN08S	25-28	630
10	14.00	32.50	10.00	7.00	M18X1.5-6H	22.00	XWN10S	WN10S	27-30	630
12	16.30	33.50	12.00	8.00	M20X1.5-6H	24.00	XWN12S	WN12S	43-54	630
14	17.00	39.50	14.00	10.00	M22X1.5-6H	27.00	XWN14S	WN14S	50-62	630
16	19.50	38.00	16.00	11.00	M24X1.5-6H	30.00	XWN16S	WN16S	60-75	400
20	24.00	44.00	20.00	14.00	M30X2.0-6H	36.00	XWN20S	WN20S	90-110	400
25	29.00	49.00	25.00	17.00	M36X2.0-6H	46.00	XWN25S	WN25S	125-145	400
30	35.00	52.00	30.00	22.00	M42X2.0-6H	50.00	XWN30S	WN30S	170-190	250
38	43.00	56.50	38.00	28.00	M52X2.0-6H	60.00	XWN38S	WN38S	200-245	250

Material	Suffix surface and material	Example
Steel ,Zinc plated chrome (VI)-free		XWN06L
Steel ,Zinc nickel plated	ZiNi	XWN06L-ZiNi
Stainless Steel-SS316 Ti	SST	XWN06L-SST
Stainless Steel-SS316	SS316	XWN06L-SS
Stainless Steel-SS304	SS304	XWN06L-S